

DRAWING MADE IN THIRD ANGLE PROJECTION

© COPYRIGHT 1978 BY AMP INCORPORATED, HARRISBURG, PA. ALL INTERNATIONAL RIGHTS RESERVED. AMP INCORPORATED PRODUCTS COVERED BY U. S. AND FOREIGN PATENTS AND/OR PATENTS PENDING.

- △ SHEET METAL SCREWS NOT SUPPLIED.
- △ INSERT IS ATTACHED TO STRAIN RELIEF. AS AN ADDITIONAL ADJUSTMENT FOR SMALL WIRE BUNDLES, IT SHOULD BE CUT OFF AND POSITIONED AS SHOWN BY DOTTED LINES.
- △ TWO REQUIRED PER CONNECTOR.
- 4. DETACHABLE INSERT MAY SEPARATE FROM STRAIN RELIEF BODY DURING SHIPPING.

REVISIONS		DATE	APPROVED
P	F		
1	REVISED AND REDRAWN PER M-5186	3-2-79	MSE/DH
2	AI RESTORATION	3-28-79	ST/ED
3	B REV PER ECN CM 705	3-18-80	TR/R5

3

2

1

LOC DIST  
CM 53

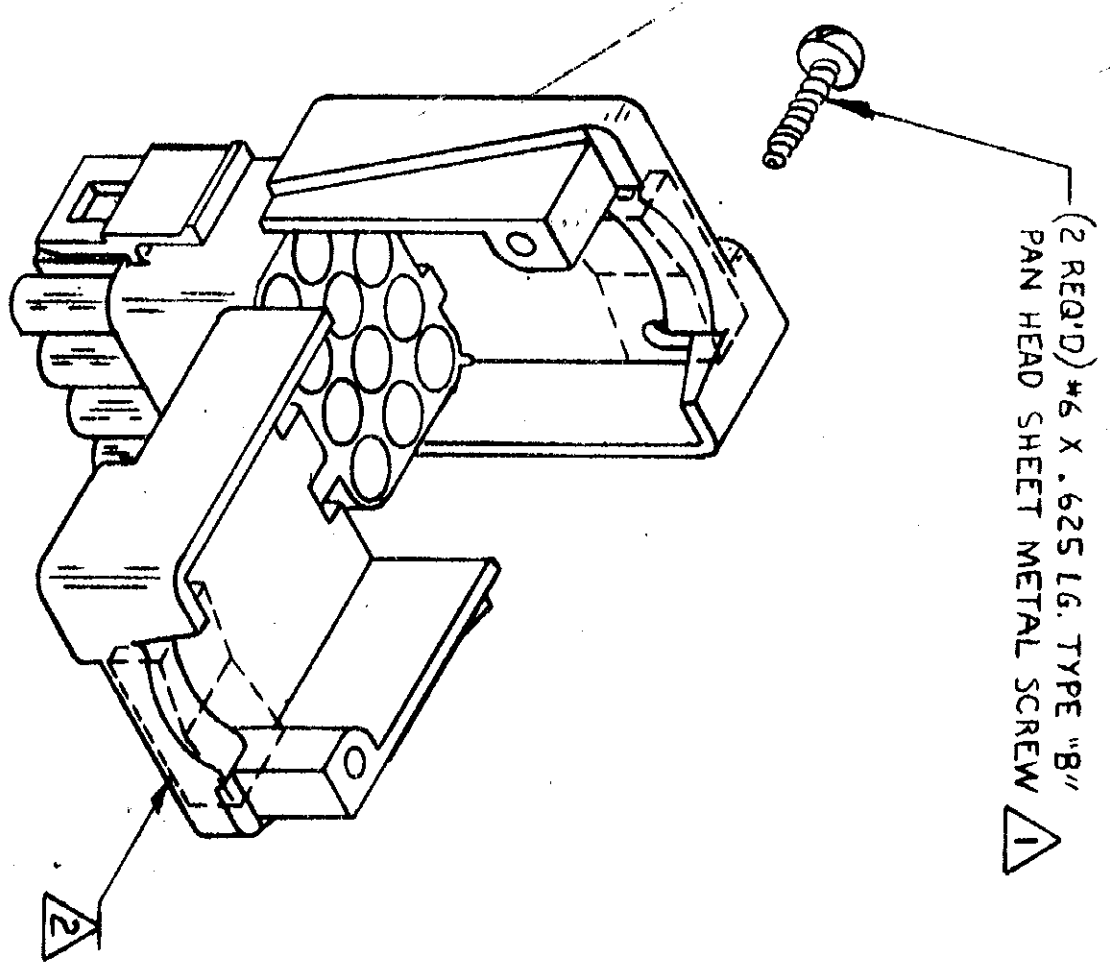
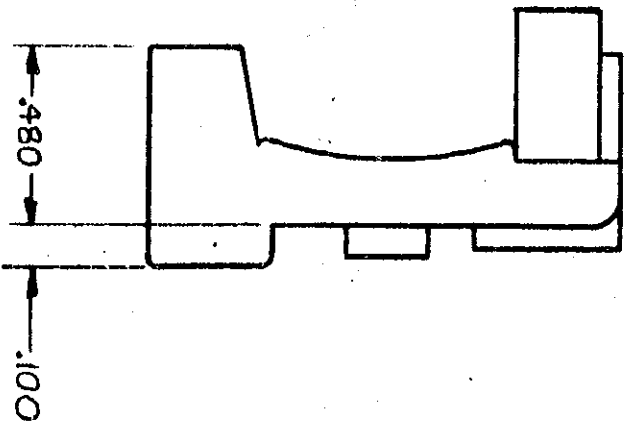
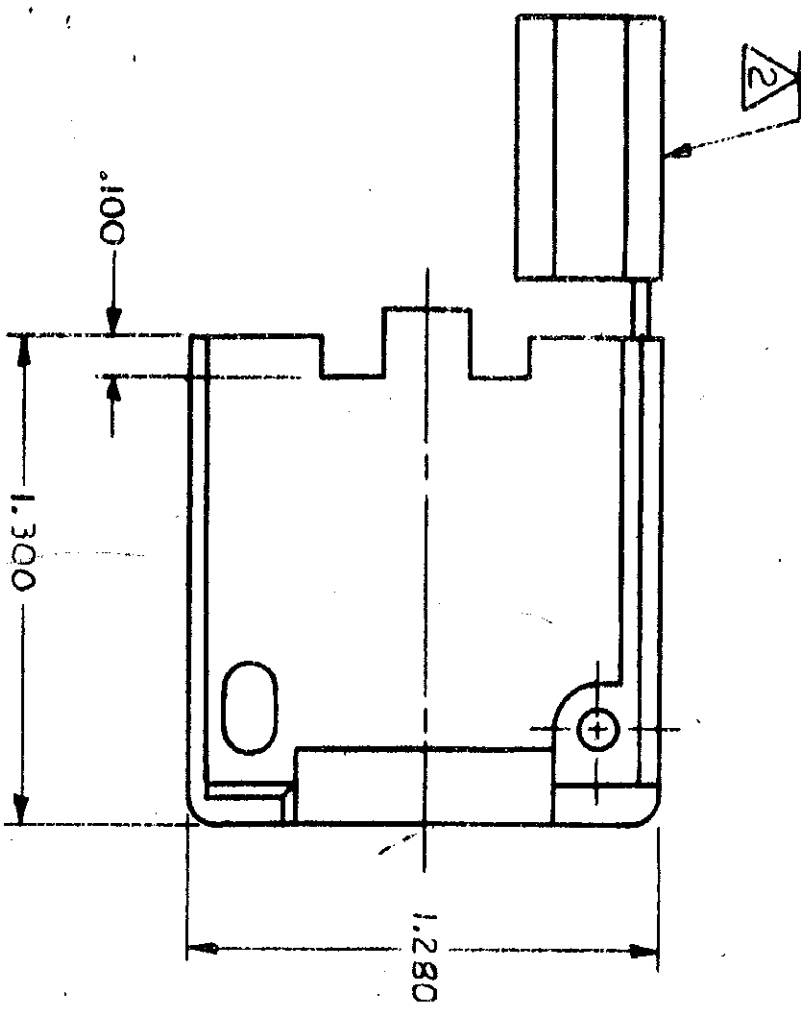
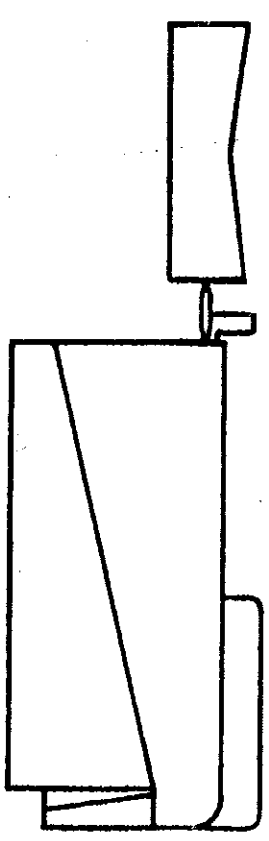

640723

WIRE BUNDLE DIA	WITHOUT INSERT	WITH INSERT
	.750 MAX	.150 MIN

UNLESS OTHERWISE SPECIFIED DIMENSIONS ARE IN INCHES. TOLERANCES ON: DECIMALS ± .015 ANGLES ±

FINISH SEE TABLE  
MATERIAL SEE TABLE  
CONTRACT NO. 3-2-79  
DR M. FEHER  
CHK J.S. Wade 3/22/79  
APPD JCR/ed 3-22-79  
APPD  
DSGN APPD  
OTHER APPD

NAME STRAIN RELIEF FOR 12 CIRCUIT UNIVERSAL MATE-N-LOK™ CONNECTOR  
MATERIAL NYLON 94V-2 | 640723-0/3  
COLOR NATURAL  
PART NO.

SIZE CODE IDENT NO DRAWING NO 640723  
SCALE 2-1  
SHEET 1 OF 1

CUSTOMER DRAWING