

TL6330 SERIES TACT SWITCH

ANTI-VANDAL SWITCHES
 DETECTOR SWITCHES
 DIP SWITCHES
 KEYLOCK SWITCHES
 NAVIGATION SWITCHES
 PUSHBUTTON SWITCHES
 ROCKER SWITCHES
 ROTARY SWITCHES
 SLIDE SWITCHES
 SNAP ACTION SWITCHES
TACTILE SWITCHES
 TOGGLE SWITCHES
 CAP OPTIONS



APPLICATIONS / MARKETS



Handheld Devices



Wearable Electronics



Internet of Things



Smart Home



Telecommunication

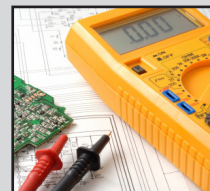

Testing Equipment

RoHS

SPECIFICATIONS

Contact Rating: 50mA @ 32VDC
Electrical Life: 200,000 Cycles
Contact Resistance: 100mΩ Max
Insulation Resistance: 1GΩ Min @ 500VDC
Dielectric Strength: 250VAC for 1 Minute
Operating Temperature: -40°C to 85°C
Storage Temperature: -55°C to 85°C
Travel: 0.25mm
Contact Arrangement: SPST
Actuation Force: 200gf
Dust/Moisture Protection: IP67

FEATURES & BENEFITS

- Surface mount PC board design
- Long Cycle Life of 200,000 Cycles
- Small package size of 2.80mm x 4.60mm x 1.90mm
- 200 gram force
- IP67 rating

PART NUMBER CONFIGURATOR

Series

TL6330

Actuator Options

A - 1.90mm

Actuation Force

F200 - 200 gf

Contact Material

Q - Silver

Specifications subject to change without notice 4.3.2018



E-SWITCH®

www.e-switch.com

800.867.2717

1

TL6330 SERIES TACT SWITCH

BODY DIMENSIONS

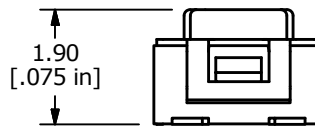
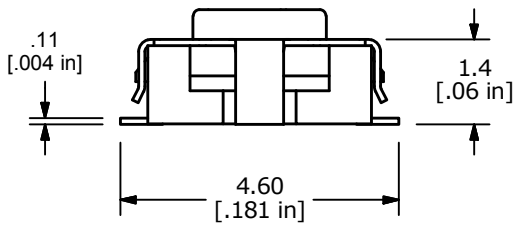
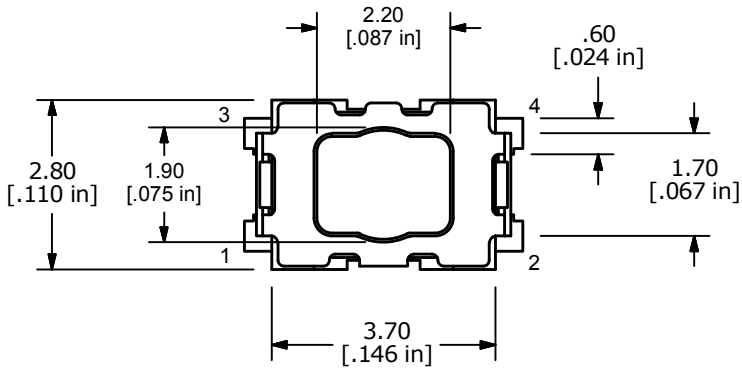
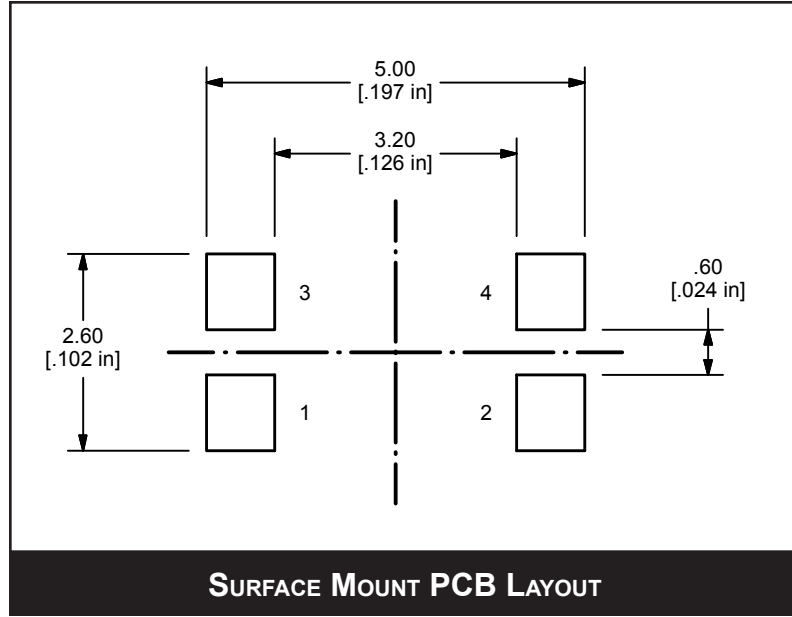
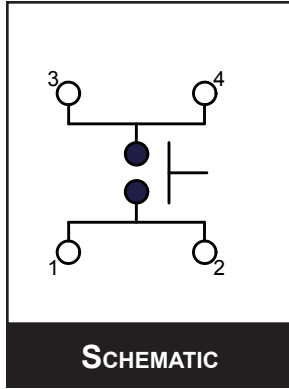

- ANTI-VANDAL SWITCHES
- DETECTOR SWITCHES
- DIP SWITCHES
- KEYLOCK SWITCHES
- NAVIGATION SWITCHES
- PUSHBUTTON SWITCHES
- ROCKER SWITCHES
- ROTARY SWITCHES
- SLIDE SWITCHES
- SNAP ACTION SWITCHES
- TACTILE SWITCHES**
- TOGGLE SWITCHES
- CAP OPTIONS