



THIS DRAWING IS UNPUBLISHED. RELEASED FOR PUBLICATION NOV., 2004.  
 © COPYRIGHT 2004 BY TYCO ELECTRONICS CORPORATION. ALL RIGHTS RESERVED.

LOC		DIST		REVISIONS			
P	LTR	DESCRIPTION	DATE	DWN	APVD		
		SEE SHEET 1					

COMPONENTS

ITEM	DESCRIPTION
2, 3 & 5	MAIN BODY (ITEM 2, 3 & 5)
1	CENTRE CONTACT (ITEM 1)
4	PUSHER SLEEVE (ITEM 4)

ASSEMBLY INSTRUCTION

CABLES: RG174A/U, 188A/U, 316/U, URM95, KX3B, KX22A

**STEP 1**  
1. SLIDE METAL CRIMP FERRULE OVER CABLE

**STEP 2**  
1. STRIP CABLE TO DIMENSIONS AS SHOWN

**STEP 3**  
1. FIT CONTACT OVER CENTRE CONDUCTOR TO BUTT AGAINST DIELECTRIC.  
2. CRIMP CONTACT USING TOOL AS NOTED ON PAGE 1 NOTE 5

**STEP 4**  
1. PRESS SUB-ASSEMBLY INTO BODY, UNTIL CONTACT IS FULLY LOCATED BY AN AUDIBLE CLICK.  
2. ENSURE THAT KNURLED HOUSING INSERTS BETWEEN THE DIELECTRIC AND CABLE BRAID.

**STEP 5**  
1. SLIDE CRIMP FERRULE ALONG THE CABLE UNTIL IT BUTTS AGAINST THE HOUSING BODY.  
2. CRIMP SLEEVE USING TOOL AS NOTED ON PAGE 1 NOTE 4  
3. CRIMP DIMENSION AS SHOWN

RECOMMENDED CRIMP SLEEVE A/F HEX

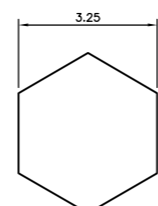

THIS DRAWING IS A CONTROLLED DOCUMENT.

DWN JSANDWELL 09NOV04	Tyco Electronics Corporation Bideford, EX39 4HE
CHK S.PARLOW 09NOV04	
APVD F.WHEELER-KING 09NOV04	
PRODUCT SPEC	
APPLICATION SPEC	NAME MCX STRAIGHT PLUG CRIMP 50 OHMS RG174, 188, 316, URM95, KX3B, 22A
WEIGHT -	SIZE A2 CAGE CODE 00779 DRAWING NO C=1337580 RESTRICTED TO -
CUSTOMER DRAWING	SCALE NTS SHEET 2 OF 2 REV E

1337580