

PART NAME	NON-METALLIC ENCLOSURE (STYLE D)	PART No.	NBD-10442 & NBD-10462 & NBD-15442
------------------	----------------------------------	-----------------	-----------------------------------

<p>MATERIAL:</p> <p><u>INDOOR VERSION</u> SOLID BODY & COVER _____ ABS/PC BLENDED PLASTIC UL94-5VB FLAMMABILITY RATING</p> <p>CLEAR COVER _____ POLYCARBONATE PLASTIC UL94V-0 FLAMMABILITY RATING UV STABILIZED</p> <p><u>OUTDOOR VERSION</u> SOLID BODY & COVER _____ PBT/PC BLENDED PLASTIC UL94-5VA FLAMMABILITY RATING UV STABILIZED</p>	<p>FINISH: BODY _____ LIGHT GRAY COVER _____ LIGHT GRAY OR CLEAR</p> <p>COVER INCLUDES GRAY POLYURETHANE GASKET.</p> <p>NOTE: COVER ATTACHES WITH PHILLIPS DRIVE NON-METALLIC SCREWS. (NOT SHOWN)</p>	<p>INDUSTRY STANDARDS:</p> <p><u>INDOOR VERSION</u> UL508 TYPE 1, 2, 4, 4X INDOOR, 12 & 13 NEMA TYPE 1, 2, 4, 4X, 12 & 13 IEC529-IP65</p> <p><u>OUTDOOR VERSION</u> UL508 TYPE 1, 2, 4, 4X, 12 & 13 NEMA TYPE 1, 2, 4, 4X, 12 & 13 IEC529-IP65</p>
--	---	---

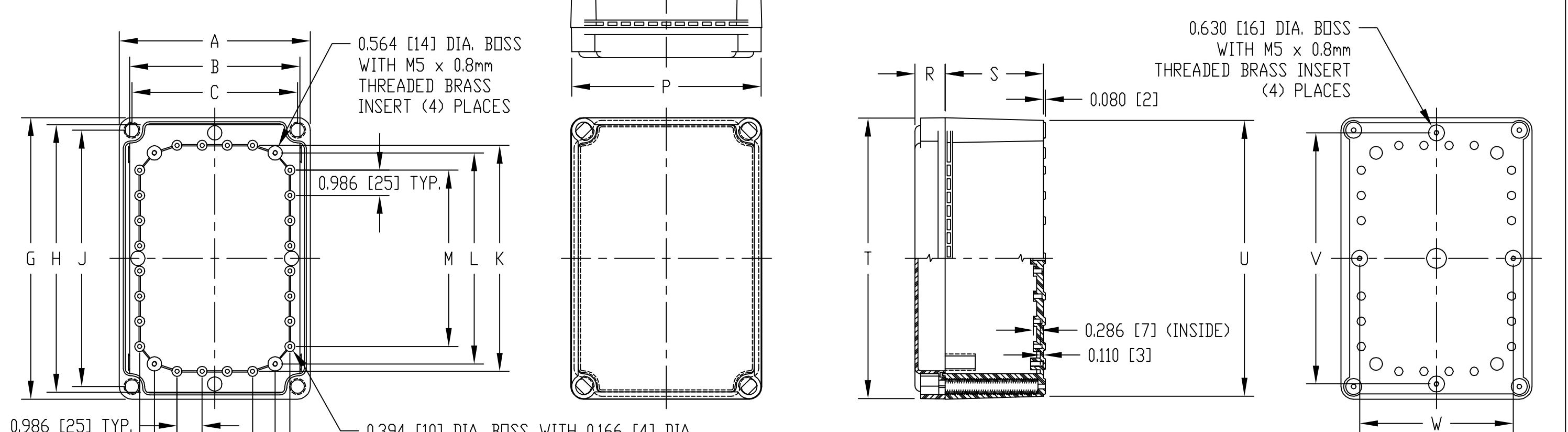

AIR AND MOISTURE VENTS, STAINLESS STEEL LOCKING HASP, PANEL MOUNTING RAILS, GALVANIZED STEEL INNER PANEL AND STAINLESS STEEL WALL MOUNTING BRACKETS ARE NOT INCLUDED, BUT CAN BE PURCHASED SEPARATELY.

DIMENSIONS = INCHES
 [MILLIMETERS]

NOTE: ALL DIMENSIONS HAVE ±0.039 [±1] TOLERANCE UNLESS OTHERWISE SPECIFIED

INDOOR VERSION		OUTDOOR VERSION	DIMENSIONS																			
PART NO.		PART NO.																				
SOLID COVER	CLEAR COVER	SOLID COVER	A	B	C	D	E	F	G	H	J	K	L	M	N	P	R	S	T	U	V	W
NBD-10442	NBD-10462	NBD-15442	7.485 [190]	6.663 [169]	6.496 [165]	5.890 [150]	4.736 [120]	2.958 [75]	11.024 [280]	10.474 [266]	10.039 [255]	8.850 [225]	8.263 [210]	6.902 [175]	7.280 [185]	7.420 [188]	1.181 [30]	3.850 [98]	10.984 [279]	10.805 [274]	9.838 [250]	6.027 [153]