

THE INFORMATION CONTAINED IN THIS DRAWING IS THE SOLE PROPERTY OF BUD INDUSTRIES INC. ANY REPRODUCTION IN PART OR WHOLE WITHOUT THE WRITTEN PERMISSION OF BUD INDUSTRIES INC. IS PROHIBITED.

| DWG. NO. SNC-3753 | |
|-------------------|-------------------------------|
| ISSUE | REVISIONS |
| (A) | REVISED DESIGN 6-30-08 DAB |
| (B) | PER ECN #10404 12-4-08 DAB |
| (C) | PER ECN #10446 1-13-09 BT |

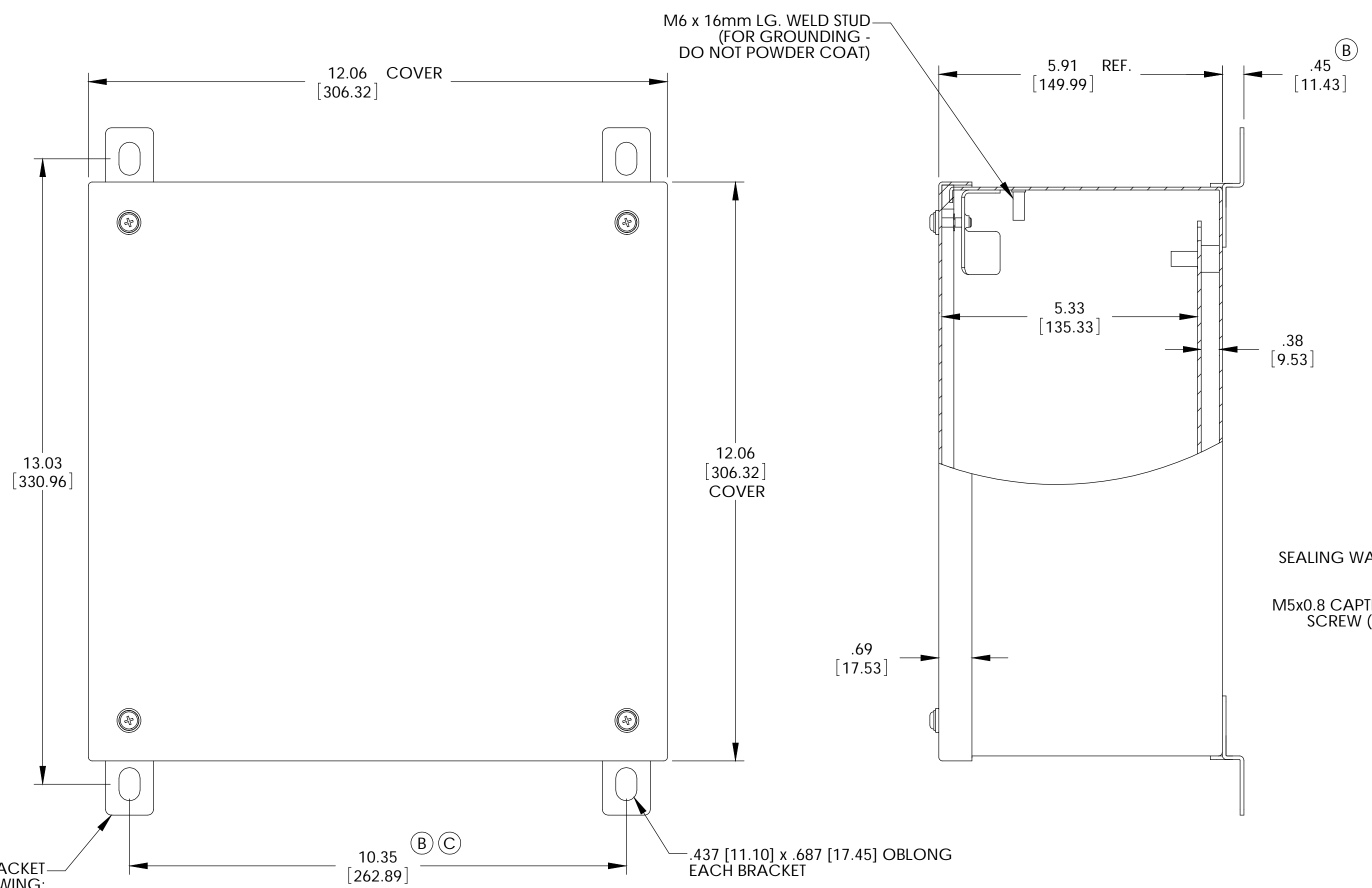

MATERIAL:
 BODY, COVER MOUNTING BRACKETS, COVER - 16 GA. [1.5mm] C.R.S.
 INTERNAL PANEL - 14 GA. [2.0mm] C.R.S.
 WALL MOUNTING BRACKETS - 14 GA. [2.0mm] STAINLESS STEEL
 HARDWARE - STAINLESS STEEL
 GASKET - .25 [6.35] THICK NEOPRENE (BLACK) OR EQUIVALENT
 SEALING WASHERS - BLACK NEOPRENE OR EQUIVALENT

FINISH:
 BODY & COVER - LIGHT GRAY SMOOTH POWDER COAT
 INTERNAL PANEL - ZINC CHROMATE
 WALL MOUNTING BRACKETS - NATURAL

RETAINING CLIP (4x)

SEALING WASHER (4x)

M5x0.8 CAPTIVE SCREW (4x)

SEE DETAIL "B" (INSIDE VIEW)

WELD & GRIND SMOOTH ALL CORNERS

NO GAP BETWEEN GASKET JOINT. OPTIONALLY JOINT MAY BE SEALED WITH ADHESIVE.

.50 TYP. [12.70]

DETAIL B
SCALE 2 : 2.75

WALL MOUNTING BRACKET KIT TO CONTAIN THE FOLLOWING:
 (4) BRACKETS, (4) BOLTS, (4) SEALING WASHERS, (4) FLAT WASHERS, (4) LOCKWASHERS & (4) HEX NUTS

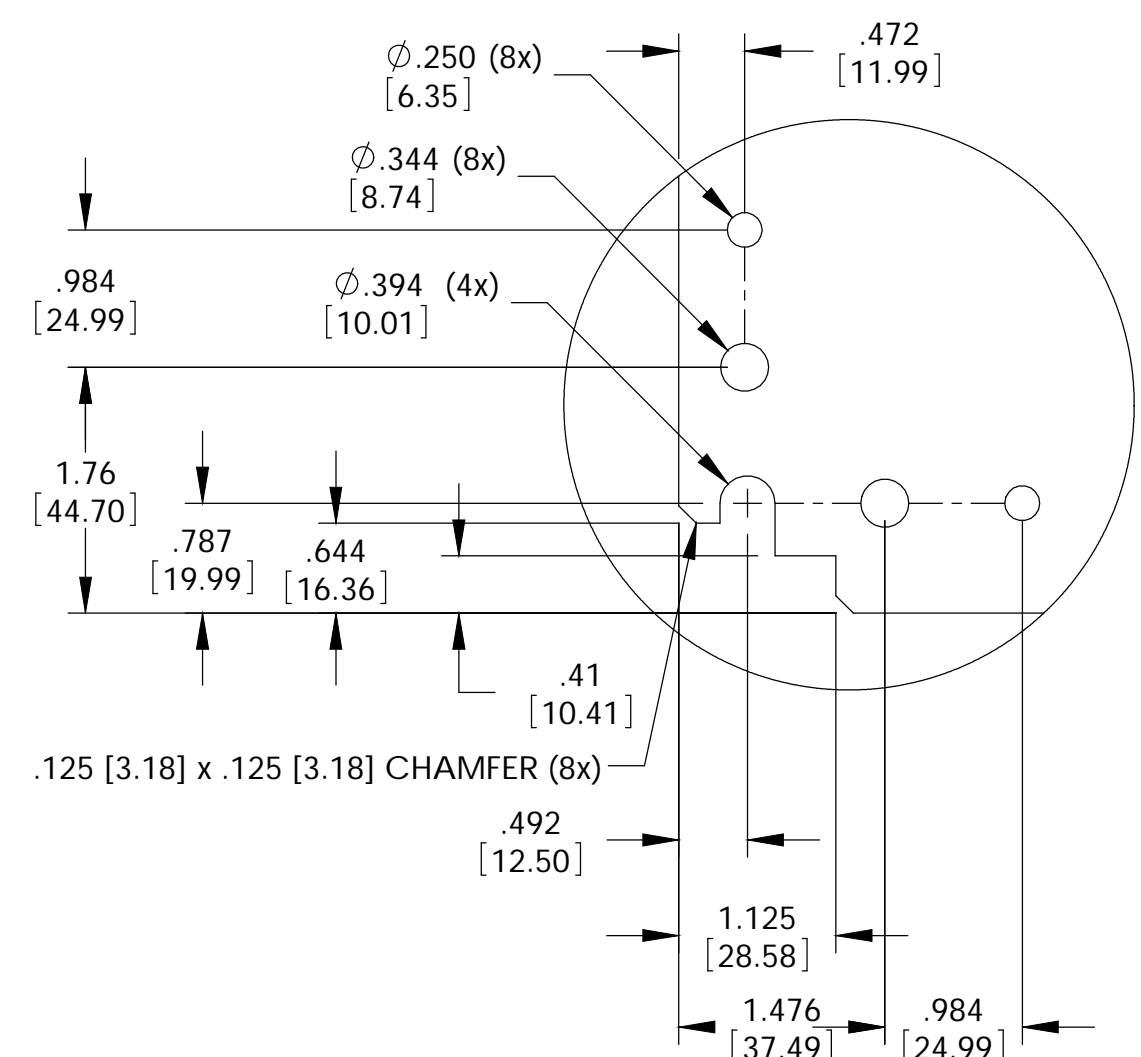
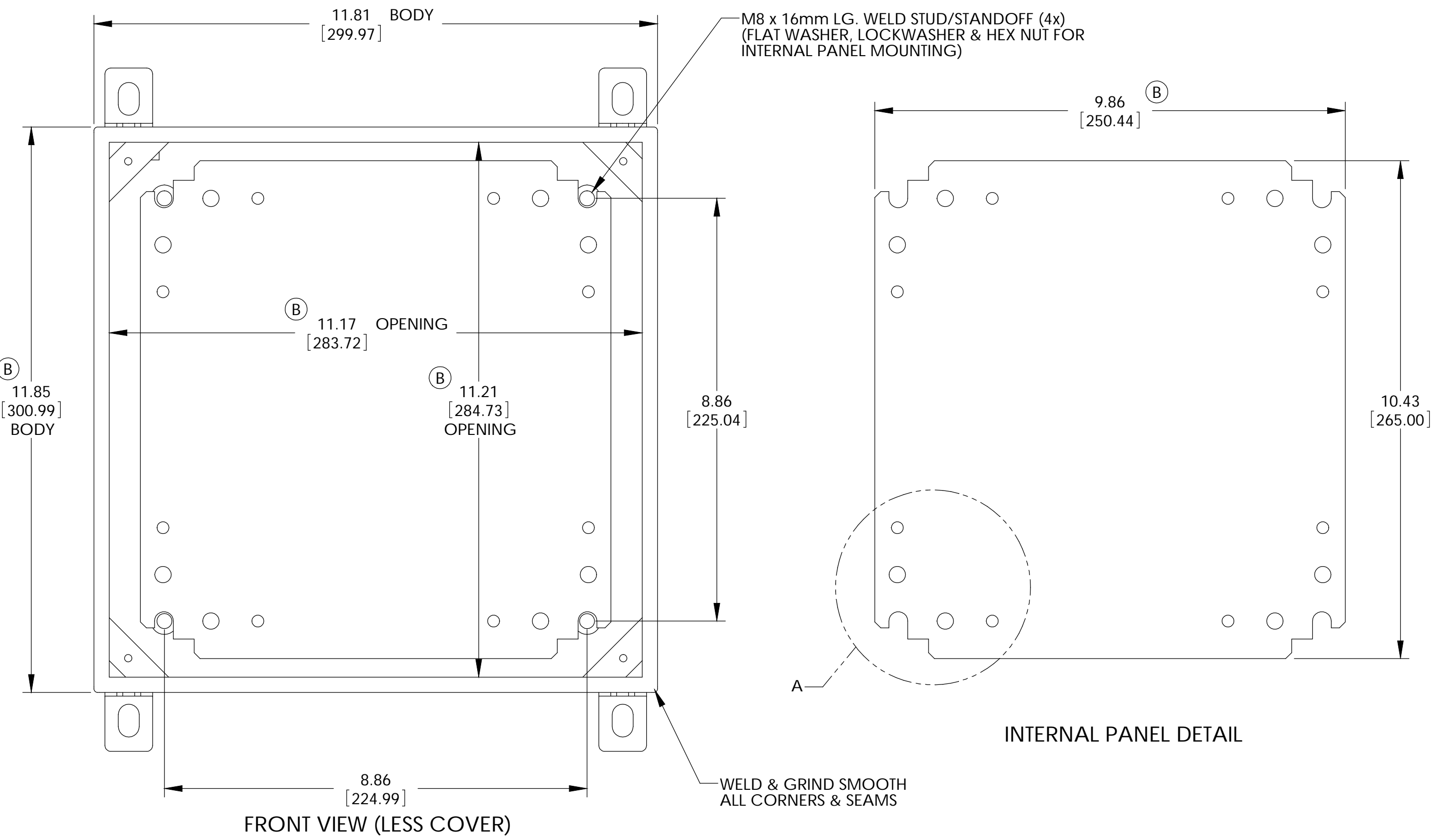

FRONT VIEW (LESS COVER)

| PARTS LIST | | BUD INDUSTRIES INC. | |
|---|--|----------------------|--------|
| UNLESS OTHERWISE SPECIFIED ALL DIMENSIONS ARE IN INCHES (MILLIMETERS) | CAD GENERATED DRAWING. DO NOT MANUALLY UPDATE. | DATE | 5-5-08 |
| TOLERANCES - DECIMALS - .015 - .03 - .001 & .010 | DRAWN BY | APPROVALS | DAB |
| MATERIAL | AS NOTED | CHECKED | DAB |
| FINISH | AS NOTED | APPROVED | |
| QTY. | USED ON | DO NOT SCALE DRAWING | |

NEMA SHEET METAL BOX w/LIFT-OFF SCREW COVER

SIZE [DWG. NO.] SNC-3753
 SCALE [CAD FILE] SHEET 1 OF 1