

| COUNT | DESCRIPTION OF REVISIONS | BY | CHKD | DATE | COUNT | DESCRIPTION OF REVISIONS | BY | CHKD | DATE |
|-------|--------------------------|----|------|------|-------|--------------------------|----|------|------|
| | | | | | | | | | |
| | | | | | | | | | |
| | | | | | | | | | |

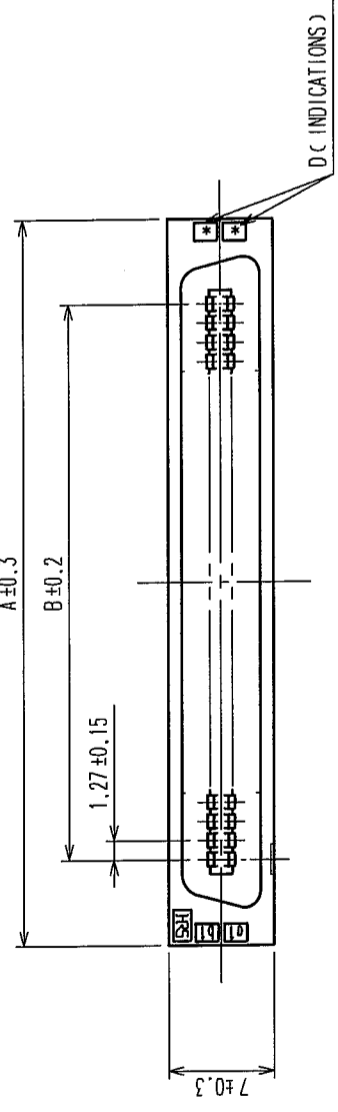

RECOMMEND PC BOARD HOLE PATTERN (MOUNTING SIDE)
t=1.6

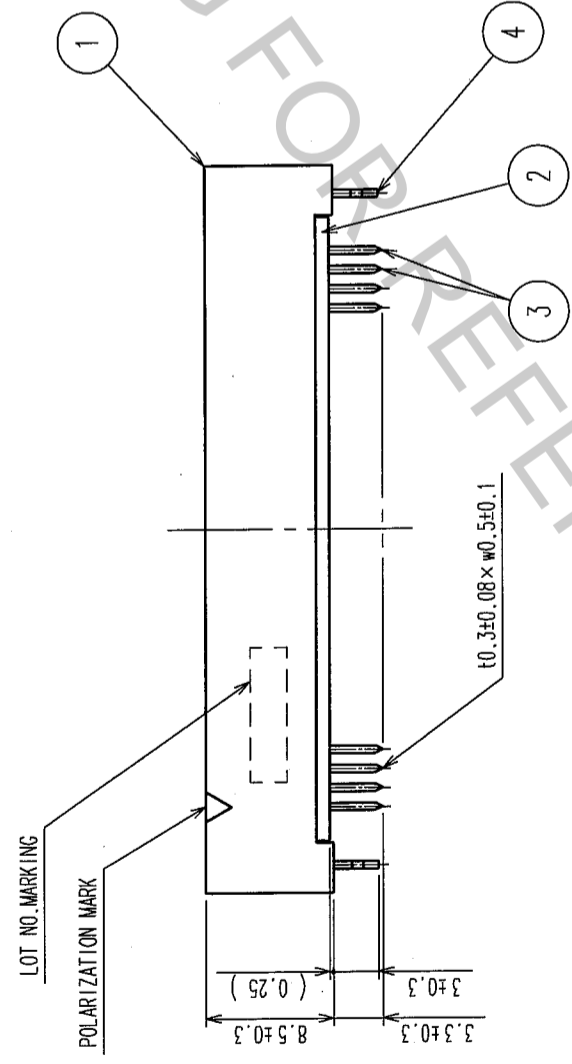
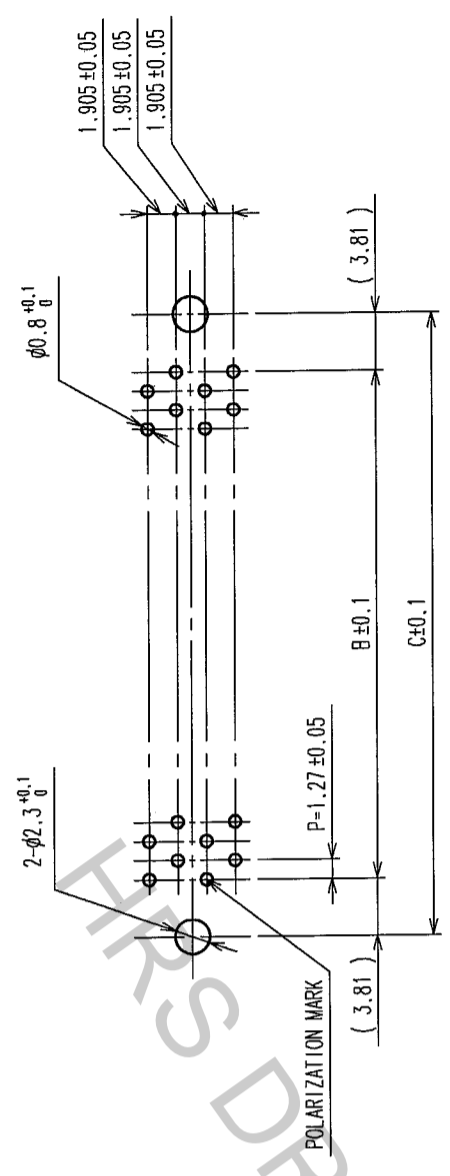

| PART No. | CODE No. | A | B | C | D |
|-------------------------|-----------------|-----|-------|-------|-------|
| FX2C-20P-1.27DSAL (71) | CL572-2251-6-71 | 20 | 22.75 | 11.43 | 19.05 |
| FX2C-32P-1.27DSAL (71) | CL572-2252-9-71 | 32 | 30.37 | 19.05 | 26.67 |
| FX2C-40P-1.27DSAL (71) | CL572-2253-1-71 | 40 | 35.45 | 24.13 | 31.75 |
| FX2C-52P-1.27DSAL (71) | CL572-2254-4-71 | 52 | 43.07 | 31.75 | 39.37 |
| FX2C-60P-1.27DSAL (71) | CL572-2255-7-71 | 60 | 48.15 | 36.83 | 44.45 |
| FX2C-68P-1.27DSAL (71) | CL572-2256-0-71 | 68 | 53.23 | 41.91 | 49.53 |
| FX2C-80P-1.27DSAL (71) | CL572-2257-2-71 | 80 | 60.85 | 49.53 | 57.15 |
| FX2C-100P-1.27DSAL (71) | CL572-2258-5-71 | 100 | 73.55 | 62.23 | 69.85 |
| FX2C-120P-1.27DSAL (71) | CL572-2259-8-71 | 120 | 86.25 | 74.93 | 82.55 |

NOTES 1. THE DIMENSIONS IN PARENTHESES ARE FOR REFERENCE.
2. NUMBER OF PIN.

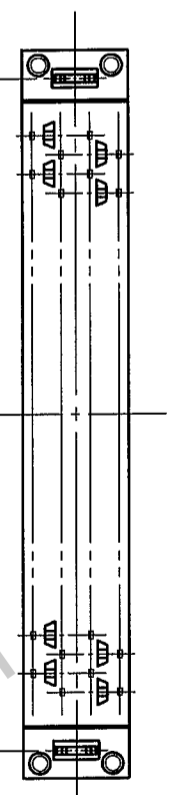

| NO. | MATERIAL | FINISH, REMARKS | NO. | MATERIAL | FINISH, REMARKS |
|-----|-----------------|-----------------|-----|-----------------|---|
| 4 | PHOSPHOR BRONZE | TIN-PLATING | 3 | PHOSPHOR BRONZE | CONTACT AREA: GOLD 0.2μm min DIP AREA: TIN-PLATING 2μm min |
| 1,2 | POLYAMIDE | BLACK UL94V-0 | | | UNDER PLATING: NICKEL 2μm min |

| CODE NO. (OLD) | CL | DRAWN | DESIGNED | CHECKED | APPROVED | RELEASED |
|----------------|----|------------|-------------|----------|----------|----------|
| | | I. OKAYAMA | K. NAKAMURA | H. OKAWA | H. OKAWA | |
| | | 04.06.02 | 04.06.02 | 04.06.09 | 04.06.09 | |

| DRAWING NO. | PART NO. |
|----------------|-------------------------|
| EDC3-083046-21 | FX2C-**-P-1.27DSAL (71) |

| SCALE | UNITS | CODE NO. |
|-------|-------|----------|
| FREE | mm | CL572 |

| | |
|-----|--|
| TO | |
| PCK | |