

KEMET Part Number: KJY222MR39DAAAA
(C805FR222M400CU)

KJY SFTY X1-400 Y2-250, Ceramic, Safety, 2200 pF, 20%, 400 VAC (X1), 250 VAC (Y2), Y5U, Lead Spacing = 7.5mm

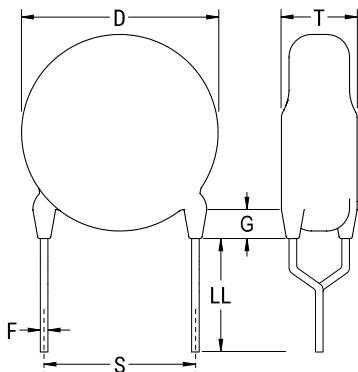

Dimensions	
D	10mm MAX
T	5mm MAX
S	7.5mm MAX
LL	25mm +/-1mm
F	0.6mm +/-0.1mm

Packaging Specifications	
Packaging:	Bulk, Bag

General Information	
Supplier:	KEMET
Series:	KJY SFTY X1-400 Y2-250
Style:	Radial Disc
RoHS:	Yes
Termination:	Tin
Failure Rate:	N/A
Qualifications:	ENEC, cUL, CQC, VDE

Specifications	
Capacitance:	2200 pF
Capacitance Tolerance:	20%
Voltage AC:	400 VAC (X1), 250 VAC (Y2)
Dielectric Withstanding Voltage:	2,600 V
Temperature Range:	-25/+85C
Temperature Coefficient:	Y5U
Dissipation Factor:	2.50%
Insulation Resistance:	10 GOhms
Safety Class:	X1/Y2