

Spring Cage Miniature Terminal Blocks FK-MPT 0,5/...-3,5

The mini print terminals, FK-MPT 0,5 and FK-MPT 0,5...-H provide one double connection per position across a 3.5 mm pitch. This space-saving arrangement is of particular advantage for looping through potentials on miniature modules.

The easy-to-use spring cage connection is suitable for solid conductors up to a cross section of 0.5 mm² or a diameter of 0.8 mm. The stripped conductors make contact automatically when inserted; it is only necessary to operate the orange lever for small cross sections or to break the connection.

The technical data is the same as for the soldered version, and a plug socket for pin strips (1 mm Ø pin) is integrated in the FK-MPT 0,5-ST.

Starting up technical equipment is a convenient matter because the printed circuit terminal blocks can be prewired and quickly installed.

The **PST 1,0/...-3,5** pin strip represents a logical supplement to the FK-MPT 0,5-ST. It is compatible with conventional pin strips, available on request in tube magazines and easy to solder in the reflow oven.

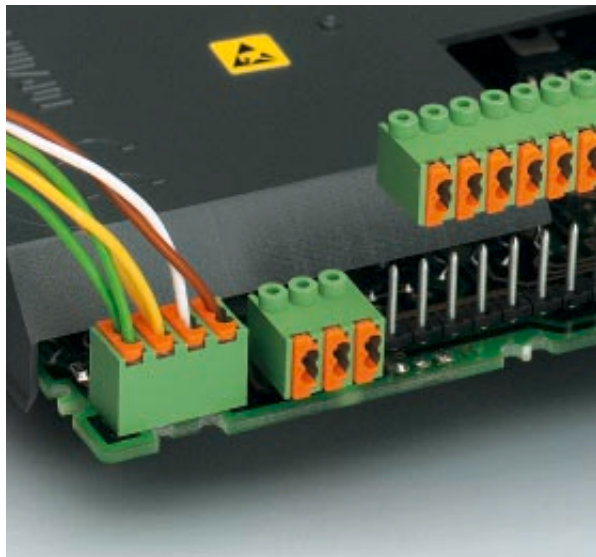

COMBICON Select

The COMBICON search engine with CAD downloading



COMBICON Select – the printed circuit board connection software supports your workflow from the PCB and housing layout to the ordering process with:

- Systematic and fast selection of products
- Universal Internet aided engineering with extensive CAD downloading
- Easy-to-use e-shopping functions.

<http://select.phoenixcontact.com>

FK-MPT 0,5 /...-3,5

3.5 mm Pitch

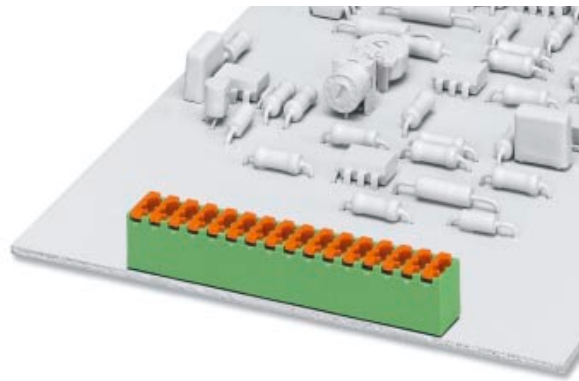

Description	No. of pos.	Dim. a [mm]	Type	Order No.	Pcs./Pkt.
Spring cage miniature terminal block, 3.5 mm pitch, color: green					
	2	3.5	FK-MPT 0,5/2-3,5	18 91 06 9	50
	3	7	FK-MPT 0,5/3-3,5	18 91 07 2	
	4	10.5	FK-MPT 0,5/4-3,5	18 91 08 5	
	5	14	FK-MPT 0,5/5-3,5	18 91 09 8	
	6	17.5	FK-MPT 0,5/6-3,5	18 91 10 8	
	7	21	FK-MPT 0,5/7-3,5	18 91 11 1	
	8	24.5	FK-MPT 0,5/8-3,5	18 91 12 4	
	9	28	FK-MPT 0,5/9-3,5	18 91 13 7	
	10	31.5	FK-MPT 0,5/10-3,5	18 91 14 0	
	11	35	FK-MPT 0,5/11-3,5	18 91 15 3	
	12	38.5	FK-MPT 0,5/12-3,5	18 91 16 6	
	13	42	FK-MPT 0,5/13-3,5	18 91 17 9	
	14	45.5	FK-MPT 0,5/14-3,5	18 91 18 2	
	15	49	FK-MPT 0,5/15-3,5	18 91 19 5	
	16	52.5	FK-MPT 0,5/16-3,5	18 91 20 5	

Technical data

Dimensions		see description		
Pitch	[mm]	3.5		
Hole diameter	[mm]	1		
Pin dimensions	[mm]	0.4 x 0.9		
Technical data in accordance with IEC / DIN VDE				
Insulating material group	-	IIIa		
Surge voltage category / contamination class	-/-	III / 3	III / 2	II / 2
Rated voltage	[V]	160	250	250
Rated surge voltage	[kV]	2.5	2.5	2.5
Nominal current / cross section	[A]/[mm ²]	4 / 0.5		
Maximum load current / cross section	[A]/[mm ²]	4 / 0.5		
Capacity connection				
Solid / stranded / conductor sizes	[mm ²]/[mm ²]/AWG	0.12 - 0.5 / — / 28 - 20		
Stranded with ferrule without / with plastic sleeve	[mm ²]	—		
Stripping length	[mm]	6.5		
Internal cylindrical gauge (IEC 60 947-1)	-	—		
Insulating material				
Inflammability class in acc. with UL 94		PBT		
		V0		
Approval data (UL/CUL and CSA)				
Nominal voltage / current / conductor sizes	UL/CUL:[V] / [A] / AWG CSA:[V] / [A] / AWG	300 / 4 / 28 - 20		
		—		

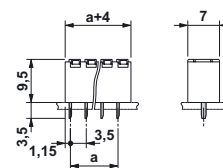
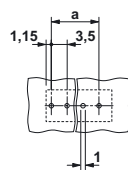

FK-MPT 0,5 /...ST-3,5 3.5 mm Pitch

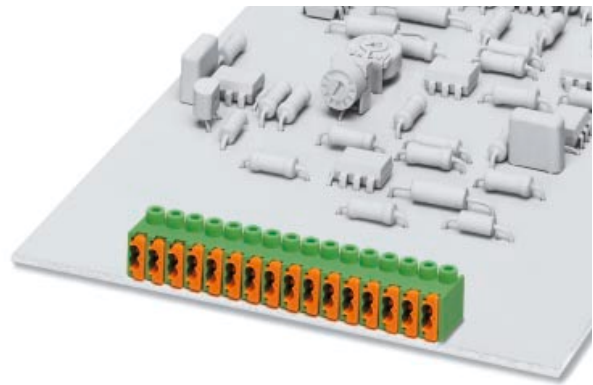

Description	No. of pos. ¹⁾	Dim. a [mm]	Type	Order No.	Pcs./Pkt.
Spring cage miniature terminal block, 3.5 mm pitch, color: green					
	2	3.5	FK-MPT 0,5/2-ST-3,5	19 13 92 1	50
	3	7	FK-MPT 0,5/3-ST-3,5	19 13 93 4	
	4	10.5	FK-MPT 0,5/4-ST-3,5	19 13 94 7	
	5	14	FK-MPT 0,5/5-ST-3,5	19 13 95 0	
	6	17.5	FK-MPT 0,5/6-ST-3,5	19 13 96 3	
	7	21	FK-MPT 0,5/7-ST-3,5	19 13 97 6	
	8	24.5	FK-MPT 0,5/8-ST-3,5	19 13 98 9	
	9	28	FK-MPT 0,5/9-ST-3,5	19 13 99 2	
	10	31.5	FK-MPT 0,5/10-ST-3,5	19 14 00 1	
	11	35	FK-MPT 0,5/11-ST-3,5	19 14 02 7	
	12	38.5	FK-MPT 0,5/12-ST-3,5	19 14 03 0	
	13	42	FK-MPT 0,5/13-ST-3,5	19 14 04 3	
	14	45.5	FK-MPT 0,5/14-ST-3,5	19 14 05 6	
	15	49	FK-MPT 0,5/15-ST-3,5	19 14 06 9	
	16	52.5	FK-MPT 0,5/16-ST-3,5	19 14 07 2	

Technical data

Dimensions		see description
Pitch	[mm]	3.5
Hole diameter	[mm]	Dependent on the pin strip used
Pin dimensions	[mm]	Dependent on the pin strip used
Technical data in accordance with IEC / DIN VDE		
Insulating material group	—	IIIa
Surge voltage category / contamination class	—/—	III / 3 III / 2 II / 2
Rated voltage	[V]	160 250 250
Rated surge voltage	[kV]	2.5 2.5 2.5
Nominal current / cross section	[A]/[mm ²]	4 / 0.5
Maximum load current / cross section	[A]/[mm ²]	4 / 0.5
Capacity connection		
Solid / stranded / conductor sizes	[mm ²]/[mm ²]/AWG	0.12 - 0.5 / — / 28 - 20
Stranded with ferrule without / with plastic sleeve	[mm ²]	—
Stripping length	[mm]	6.5
Internal cylindrical gauge (IEC 60 947-1)	—	
Insulating material		
Inflammability class in acc. with UL 94		PBT V0
Approval data (UL/CUL and CSA)		
Nominal voltage / current / conductor sizes	UL/CUL:[V] / [A] / AWG CSA:[V] / [A] / AWG	300 / 4 / 28 - 20 —

¹⁾ Further number of positions on request.

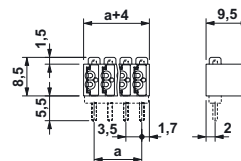

Pin Strip PST 1,0/...-3,5 3.5 mm Pitch

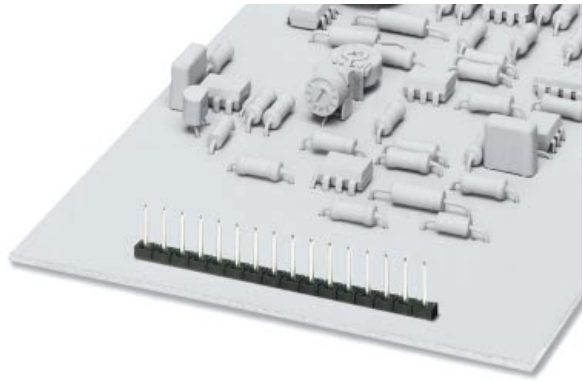

Description	No. of pos.	Dim. a [mm]	Type	Order No.	Pcs./Pkt.
Pin strip, 3.5 mm pitch, for use with mini printed circuit terminal blocks FK-MPT 0,5/...-ST-3,5 color: black	2	3.5	PST 1,0/2-3,5	19 45 09 6	50 ¹⁾
	3	7	PST 1,0/3-3,5	19 45 10 6	
	4	10.5	PST 1,0/4-3,5	19 45 11 9	
	5	14	PST 1,0/5-3,5	19 45 12 2	
	6	17.5	PST 1,0/6-3,5	19 45 13 5	
	7	21	PST 1,0/7-3,5	19 45 14 8	
	8	24.5	PST 1,0/8-3,5	19 45 15 1	
	9	28	PST 1,0/9-3,5	19 45 16 4	
	10	31.5	PST 1,0/10-3,5	19 45 17 7	
	11	35	PST 1,0/11-3,5	19 45 18 0	
	12	38.5	PST 1,0/12-3,5	19 45 19 3	
	13	42	PST 1,0/13-3,5	19 45 20 3	
	14	45.5	PST 1,0/14-3,5	19 45 21 6	
	15	49	PST 1,0/15-3,5	19 45 22 9	
	16	52.5	PST 1,0/16-3,5	19 45 23 2	

Technical data

Dimensions	
Pitch	[mm]
Hole diameter	[mm]
Pin dimensions	[mm]x[mm]

Technical data in accordance with IEC/ DIN VDE

Insulating material group	-
Surge voltage category / contamination class	-/-
Rated voltage	[V]
Rated surge voltage	[kV]
Nominal current / cross section	[A]
Maximum load current / cross section	[A]

Insulating material

Inflammability class in acc. with UL 94

Approval data (UL/CUL and CSA)

Nominal voltage / current / conductor sizes	UL/CUL: [V]/[A]/AWG
	CSA: [V]/[A]/AWG

see description

3.5

1.2

∅ 1

IIIa

III/2

160

250

2.5

2.5

2.5

8²⁾ / -

8²⁾ / -

PA

V0

300 / 10 / --

--

¹⁾ Larger packaging units are available on request.

²⁾ The maximum current depends on the plug used. The lower value of the two for plug and pin strip is the deciding factor.

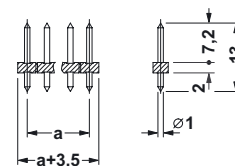
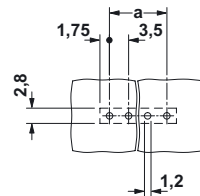

FK-MPT 0,5 /...-3,5-H 3.5 mm Pitch

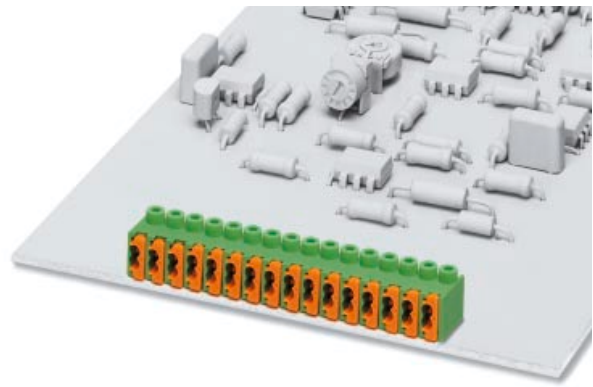

Description	No. of pos.	Dim. a [mm]	Type	Order No.	Pcs./Pkt.
Spring cage miniature terminal block, 3.5 mm pitch, color: green					
	2	3.5	FK-MPT 0,5/2-3,5-H	19 28 76 7	50
	3	7	FK-MPT 0,5/3-3,5-H	19 28 77 0	
	4	10.5	FK-MPT 0,5/4-3,5-H	19 28 78 3	
	5	14	FK-MPT 0,5/5-3,5-H	19 28 79 6	
	6	17.5	FK-MPT 0,5/6-3,5-H	19 28 80 6	
	7	21	FK-MPT 0,5/7-3,5-H	19 28 81 9	
	8	24.5	FK-MPT 0,5/8-3,5-H	19 28 82 2	
	9	28	FK-MPT 0,5/9-3,5-H	19 28 83 5	
	10	31.5	FK-MPT 0,5/10-3,5-H	19 28 84 8	
	11	35	FK-MPT 0,5/11-3,5-H	19 28 85 1	
	12	38.5	FK-MPT 0,5/12-3,5-H	19 28 86 4	
	13	42	FK-MPT 0,5/13-3,5-H	19 28 87 7	
	14	45.5	FK-MPT 0,5/14-3,5-H	19 28 88 0	
	15	49	FK-MPT 0,5/15-3,5-H	19 28 89 3	
	16	52.5	FK-MPT 0,5/16-3,5-H	19 28 90 3	

Technical data

Dimensions		see description		
Pitch	[mm]	3.5		
Hole diameter	[mm]	1.1		
Pin dimensions	[mm]	Ø 1		
Technical data in accordance with IEC / DIN VDE				
Insulating material group	-	IIIa		
Surge voltage category / contamination class	-/-	III / 3	III / 2	II / 2
Rated voltage	[V]	160	250	250
Rated surge voltage	[kV]	2.5	2.5	2.5
Nominal current / cross section	[A]/[mm ²]	4 / 0.5		
Maximum load current / cross section	[A]/[mm ²]	4 / 0.5		
Capacity connection				
Solid / stranded / conductor sizes	[mm ²]/[mm ²]/AWG	0.12 - 0.5 / — / 28 - 20		
Stranded with ferrule without / with plastic sleeve	[mm ²]	—		
Stripping length	[mm]	6.5		
Internal cylindrical gauge (IEC 60 947-1)	-	—		
Insulating material				
Inflammability class in acc. with UL 94		PBT		
		V0		
Approval data (UL/CUL and CSA)				
Nominal voltage / current / conductor sizes	UL/CUL:[V] / [A] / AWG CSA:[V] / [A] / AWG	300 / 4 / 28 - 20		
		—		

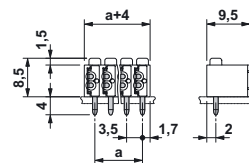
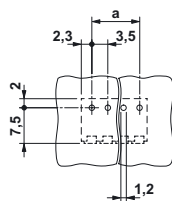

FK-MPT 0,5 /...-3,5-ICA 3.5 mm Pitch

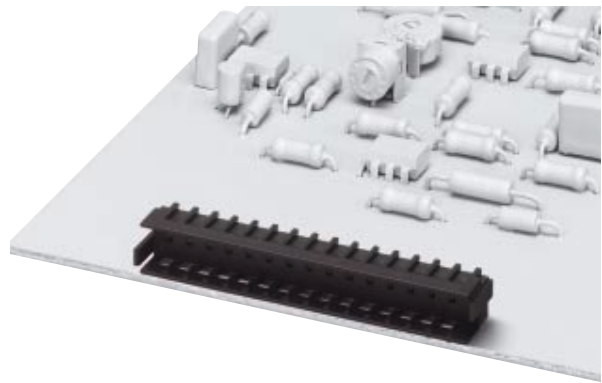

Description	No. of pos.	Dim. a [mm]	Type	Order No.	Pcs./Pkt.
Spring cage miniature terminal block, 3.5 mm pitch, color: green					
	2	3.5	FK-MPT 0,5/2-ICA-3,5	19 30 32 8	50
	3	7	FK-MPT 0,5/3-ICA-3,5	19 30 33 1	
	4	10.5	FK-MPT 0,5/4-ICA-3,5	19 30 34 4	
	5	14	FK-MPT 0,5/5-ICA-3,5	19 30 35 7	
	6	17.5	FK-MPT 0,5/6-ICA-3,5	19 30 36 0	
	7	21	FK-MPT 0,5/7-ICA-3,5	19 30 37 3	
	8	24.5	FK-MPT 0,5/8-ICA-3,5	19 30 38 6	
	9	28	FK-MPT 0,5/9-ICA-3,5	19 30 39 9	
	10	31.5	FK-MPT 0,5/10-ICA-3,5	19 30 40 9	
	11	35	FK-MPT 0,5/11-ICA-3,5	19 30 41 2	
	12	38.5	FK-MPT 0,5/12-ICA-3,5	19 30 42 5	
	13	42	FK-MPT 0,5/13-ICA-3,5	19 30 43 8	
	14	45.5	FK-MPT 0,5/14-ICA-3,5	19 30 44 1	
	15	49	FK-MPT 0,5/15-ICA-3,5	19 30 45 4	
	16	52.5	FK-MPT 0,5/16-ICA-3,5	19 30 46 7	

Technical data

Dimensions		see description		
Pitch	[mm]	3.5		
Hole diameter	[mm]	1		
Pin dimensions	[mm]	0.3 x 0.9		
Technical data in accordance with IEC / DIN VDE				
Insulating material group	-	IIIa		
Surge voltage category / contamination class	-/-	III / 3	III / 2	II / 2
Rated voltage	[V]	160	250	250
Rated surge voltage	[kV]	2.5	2.5	2.5
Nominal current / cross section	[A]/[mm ²]	3 / -		
Maximum load current / cross section	[A]/[mm ²]	3 / -		
Capacity connection				
Solid / stranded / conductor sizes	[mm ²]/[mm ²]/AWG	-		
Stranded with ferrule without / with plastic sleeve	[mm ²]	-		
Stripping length				
Internal cylindrical gauge (IEC 60 947-1)	-	-		
Insulating material				
Inflammability class in acc. with UL 94		PA		
Approval data (UL/CUL and CSA)				
Nominal voltage / current / conductor sizes	UL/CUL:[V] / [A] / AWG CSA:[V] / [A] / AWG	300 / 4 / --		

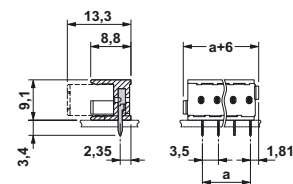
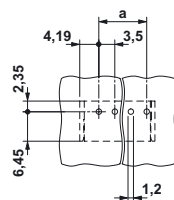

FK-MPT 0,5 /...-3,5-ICVA 3.5 mm Pitch

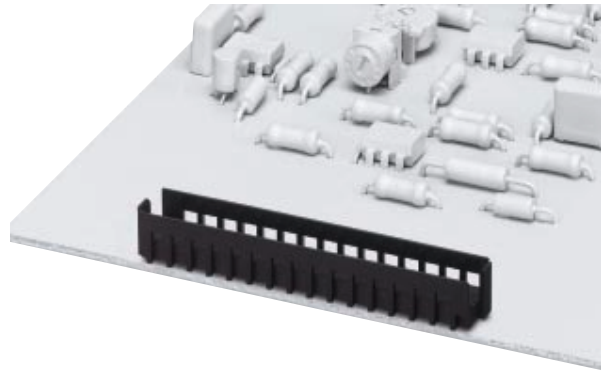

Description	No. of pos.	Dim. a [mm]	Type	Order No.	Pcs./Pkt.
Spring cage miniature terminal block, 3.5 mm pitch, color: green					
	2	3.5	FK-MPT 0,5/2-ICVA-3,5	19 30 47 0	50
	3	7	FK-MPT 0,5/3-ICVA-3,5	19 30 48 3	
	4	10.5	FK-MPT 0,5/4-ICVA-3,5	19 30 49 6	
	5	14	FK-MPT 0,5/5-ICVA-3,5	19 30 50 6	
	6	17.5	FK-MPT 0,5/6-ICVA-3,5	19 30 51 9	
	7	21	FK-MPT 0,5/7-ICVA-3,5	19 30 52 2	
	8	24.5	FK-MPT 0,5/8-ICVA-3,5	19 30 53 5	
	9	28	FK-MPT 0,5/9-ICVA-3,5	19 30 54 8	
	10	31.5	FK-MPT 0,5/10-ICVA-3,5	19 30 55 1	
	11	35	FK-MPT 0,5/11-ICVA-3,5	19 30 56 4	
	12	38.5	FK-MPT 0,5/12-ICVA-3,5	19 30 57 7	
	13	42	FK-MPT 0,5/13-ICVA-3,5	19 30 58 0	
	14	45.5	FK-MPT 0,5/14-ICVA-3,5	19 30 59 3	
	15	49	FK-MPT 0,5/15-ICVA-3,5	19 30 60 3	
	16	52.5	FK-MPT 0,5/16-ICVA-3,5	19 30 61 6	

Technical data

Dimensions		see description		
Pitch	[mm]	3.5		
Hole diameter	[mm]	1		
Pin dimensions	[mm]	0.3 x 0.9		
Technical data in accordance with IEC / DIN VDE				
Insulating material group	-	IIIa		
Surge voltage category / contamination class	-/-	III / 3	III / 2	II / 2
Rated voltage	[V]	160	250	250
Rated surge voltage	[kV]	2.5	2.5	2.5
Nominal current / cross section	[A]/[mm ²]	3 / -		
Maximum load current / cross section	[A]/[mm ²]	3 / -		
Capacity connection				
Solid / stranded / conductor sizes	[mm ²]/[mm ²]/AWG	-		
Stranded with ferrule without / with plastic sleeve	[mm ²]	-		
Stripping length				
Internal cylindrical gauge (IEC 60 947-1)	-	-		
Insulating material				
Inflammability class in acc. with UL 94		PA		
Approval data (UL/CUL and CSA)				
Nominal voltage / current / conductor sizes	UL/CUL:[V] / [A] / AWG CSA:[V] / [A] / AWG	300 / 4 / --		

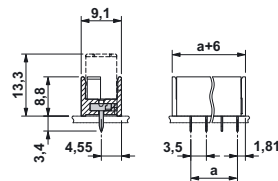
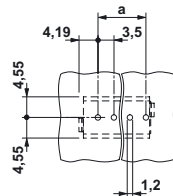

30.04.05 TNR: 5097995-06

© Phoenix Contact 2005