

Cell Type CR2430 Specifications

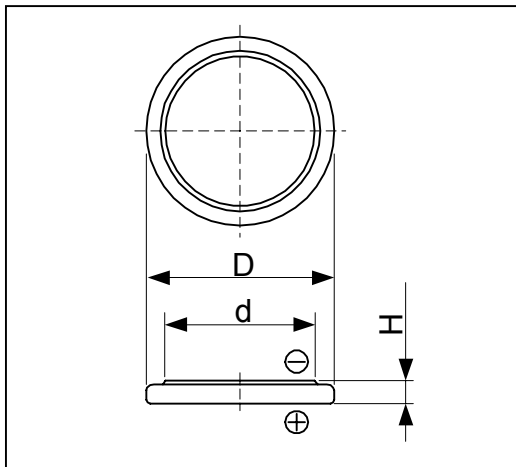

Nominal Capacity* ¹		280mAh
Nominal Voltage		3V
Standard Charge/Discharge Current		0.3mA
Max. Discharge Current	Continuous* ²	5mA
	Pulse* ³	50mA
Temperature Range		-20°C ~ 70°C
Weight		4.0g
Dimensions	D	24.5mm
	H	3.0mm
	d	20.0mm

*1 Nominal capacity is determined to an end voltage of 2.0V when the battery is allowed to discharge at a standard current level at 23°C.

*2 Current value is determined to be the level at which 50% of the nominal capacity is obtained with an end voltage of 2.0V at 23°C.

*3 Current value for obtaining 2.0V cell voltage when pulse is applied for 15seconds at 50% discharge depth at 23°C.

Typical Characteristics

Discharge Characteristics of CR2430

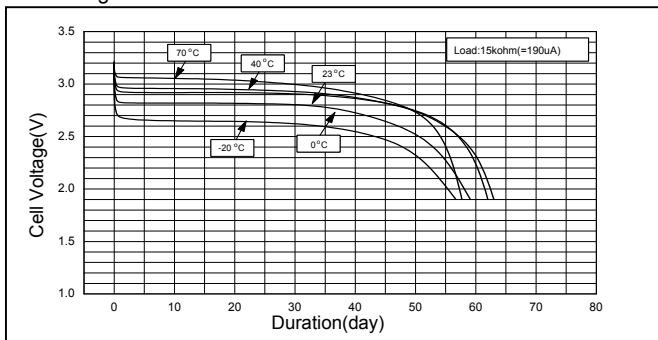

Discharge Characteristics of CR2430

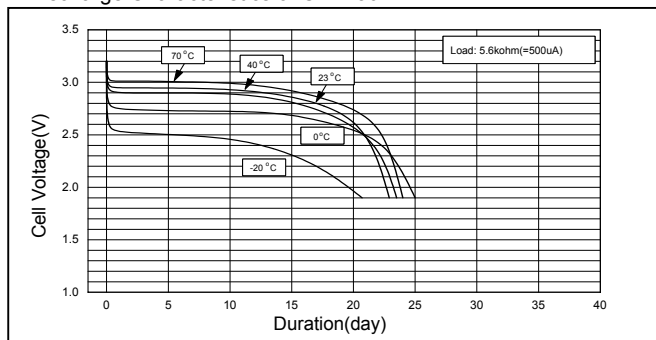

Discharge Characteristics of CR2430

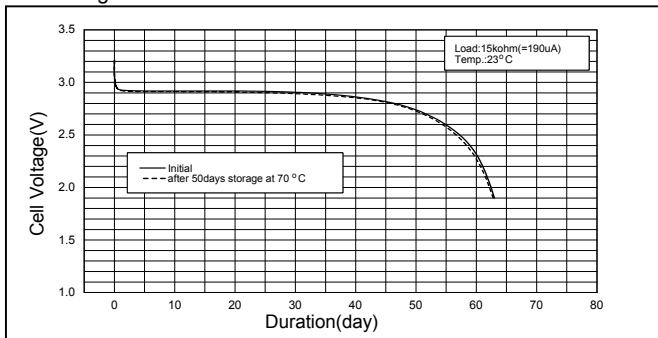

Discharge Load vs. Capacity of CR2430

