

**NOTES:**

- ① MAT'L: COPPER (STOCK TKN.  $\frac{.031}{.79}$  )  $\pm .001$
- PLATING: ELECTRO-TIN (.0003 MIN.)

STUD SIZES: ( $\pm .005$ )

- 02 = .094
- 04 = .119
- 06 = .146
- 08 = .173
- 10 = .198
- 14 = .265
- 56 = .328
- 38 = .390

"UL" LISTING \*E32244  
 "CSA" LISTING #18689

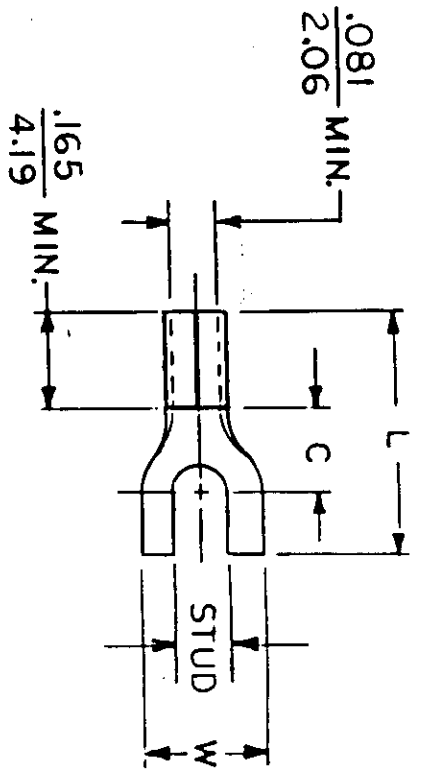

ALL DIMENSIONS =  $\frac{\text{INCHES}}{\text{M.M}}$

WIRE SIZE: 16 - 14 AWG  
 1.0 - 2.5 MM<sup>2</sup>

PART NUMBER	"W"	"C" MIN.	"L" MAX.	AVAILABLE STUD SIZES	TITLE:	
					SPADE TONGUE TERMINAL	KRIMP TITE 100-SERIES
BB-107-	$\frac{.245}{6.22}$	$\frac{.209}{5.31}$	$\frac{.565}{14.35}$	04, 06	DRWN. BY: <i>Y</i>	DATE: 10-18-84
BB-124-	$\frac{.295}{7.49}$	$\frac{.211}{5.36}$	$\frac{.564}{14.33}$	04, 06, 08	CHKD. BY: <i>GT</i>	DATE: 11-2-84
BB-127-	$\frac{.362}{9.19}$	$\frac{.269}{6.83}$	$\frac{.687}{17.45}$	06, 08, 10	APPRD. BY:	
DIMENSIONAL TOLERANCES UNLESS OTHERWISE SPECIFIED					SCALE: NTS	
FRAC. DEC. ANG.						



DWG. NO. A CUSTOMER DWG.

10	9	8	7	6	5			
MATERIAL NUMBER	ALTERNATE NUMBER	STUD SIZE	"S" ±.005/(0.13)	"W" ±.010/(0.25)	"C" MIN (A1)	"L" MAX (A1)	PACKAGING	
191410050	BB-107-04	4	.119/(3.02)	.245/(6.22)	.209/(5.31)	.565/(14.35)	LOOSE PIECE	
191410052	BB-107-06	6	.146/(3.71)	.245/(6.22)	.209/(5.31)	.565/(14.35)		
191410054	BB-124-04	4	.119/(3.02)	.295/(7.49)	.211/(5.36)	.564/(14.33)		
191410056	BB-124-06	6	.146/(3.71)	.295/(7.49)	.211/(5.36)	.564/(14.33)		
191410058	BB-124-08	8	.173/(4.39)	.295/(7.49)	.211/(5.36)	.564/(14.33)		
191410061	BB-127-06	6	.146/(3.71)	.362/(9.19)	.269/(6.83)	.687/(17.45)		
191410063	BB-127-08	8	.173/(4.39)	.388/(9.85)	.269/(6.83)	.687/(17.45)		
191410065	BB-127-10	10	.198/(5.03)	.388/(9.85)	.269/(6.83)	.687/(17.45)		
191410051	BB-107-04T	4	.119/(3.02)	.245/(6.22)	.209/(5.31)	.565/(14.35)		TAPE MOUNTED
191410053	BB-107-06T	6	.146/(3.71)	.245/(6.22)	.209/(5.31)	.565/(14.35)		
191410055	BB-124-04T	4	.119/(3.02)	.295/(7.49)	.211/(5.36)	.564/(14.33)		
191410057	BB-124-06T	6	.146/(3.71)	.295/(7.49)	.211/(5.36)	.564/(14.33)		
191410059	BB-124-08T	8	.173/(4.39)	.295/(7.49)	.211/(5.36)	.564/(14.33)		
191410062	BB-127-06T	6	.146/(3.71)	.362/(9.19)	.269/(6.83)	.687/(17.45)		
191410064	BB-127-08T	8	.173/(4.39)	.388/(9.85)	.269/(6.83)	.687/(17.45)		
191410066	BB-127-10T	10	.198/(5.03)	.388/(9.85)	.269/(6.83)	.687/(17.45)		

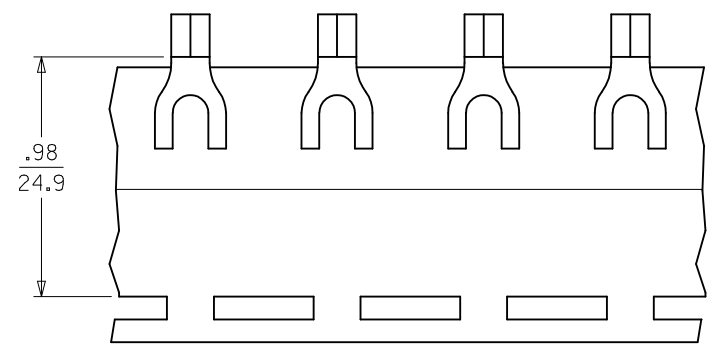

PARTS ON TAPE

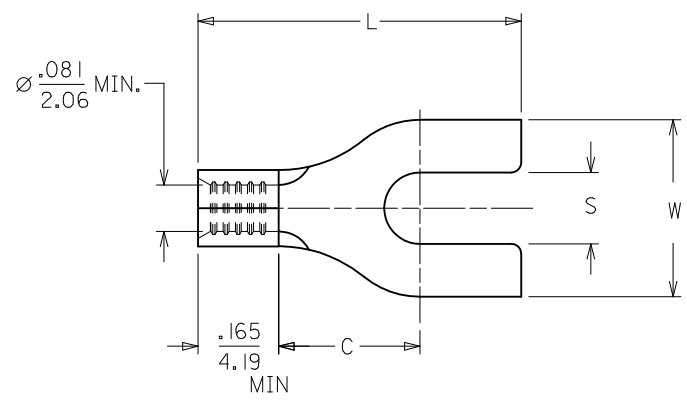

CUSTOMER DRAWING

NOTES:  
 1. MATERIAL: COPPER .031/(.79) THICK.  
 2. PLATING: ELECTRO-TIN.  
 3. PARTS ARE ROHS COMPLIANT. (A1)

ADD MISSING TOLRNC EC NO: WNA2010-0362 DRAWN: THRODAHL 2009/12/21 CHKD: JMACNEIL 2009/12/21 APPR: JMACNEIL 2009/12/21 A1	QUALITY SYMBOLS	GENERAL TOLERANCES (UNLESS SPECIFIED)	DIMENSION STYLE	SCALE	DESIGN UNITS	THIRD ANGLE PROJECTION	
	▼=0 ∇=0	mm INCH 4 PLACES ± --- ± --- 3 PLACES ± --- ± .005 2 PLACES ± 0.13 ± .01 1 PLACE ± 0.25 ± --- ANGULAR ± ---°	IN/MM	---	INCH	DRAWN BY DATE HEB 1999/11/12 CHECKED BY DATE RWD 1999/11/12 APPROVED BY DATE RWD 1999/11/12	
		DRAFT WHERE APPLICABLE MUST REMAIN WITHIN DIMENSIONS	SEE CHART	TITLE SPADE TONGUE TERMINAL 16-14 AWG KRIMPTITE SERIES		MOLEX INCORPORATED DOCUMENT NO. SD-19141-001	SHEET NO. 1 OF 1
				THIS DRAWING CONTAINS INFORMATION THAT IS PROPRIETARY TO MOLEX INCORPORATED AND SHOULD NOT BE USED WITHOUT WRITTEN PERMISSION			