

REV.	ECN NO.	REVISIONS	DRN.	CKD.	APP.	DATE
A		NEW RELEASE	AV		N.O.	12-15-97
B		ADDED (mm) DIMENSIONS; ADDED 2 INSERTS ON BOTTOM VIEW.	TC		N.O.	1-28-98
C		.104 ±.010 (2.65 ±0.25) WAS .090 ±.010 (2.29 ±0.25); REMOVED "REF" FROM DIMENSIONS ON SIDE VIEW; ADDED HOUSING CUTOUT AND REVISED SLOT ON INSERT; ADDED NOTE 3; ADDED LEAD FOR POS. 4; ON TABLE POS. 16 YELLOW WAS YEL/GRN.	TC	AV	NO	9-9-98
D	-----	ADD PACKAGING INFO	AV	DC	N.O.	2-25-99
E		REMOVED 3Com PO LABEL FROM TRAY.	TC			

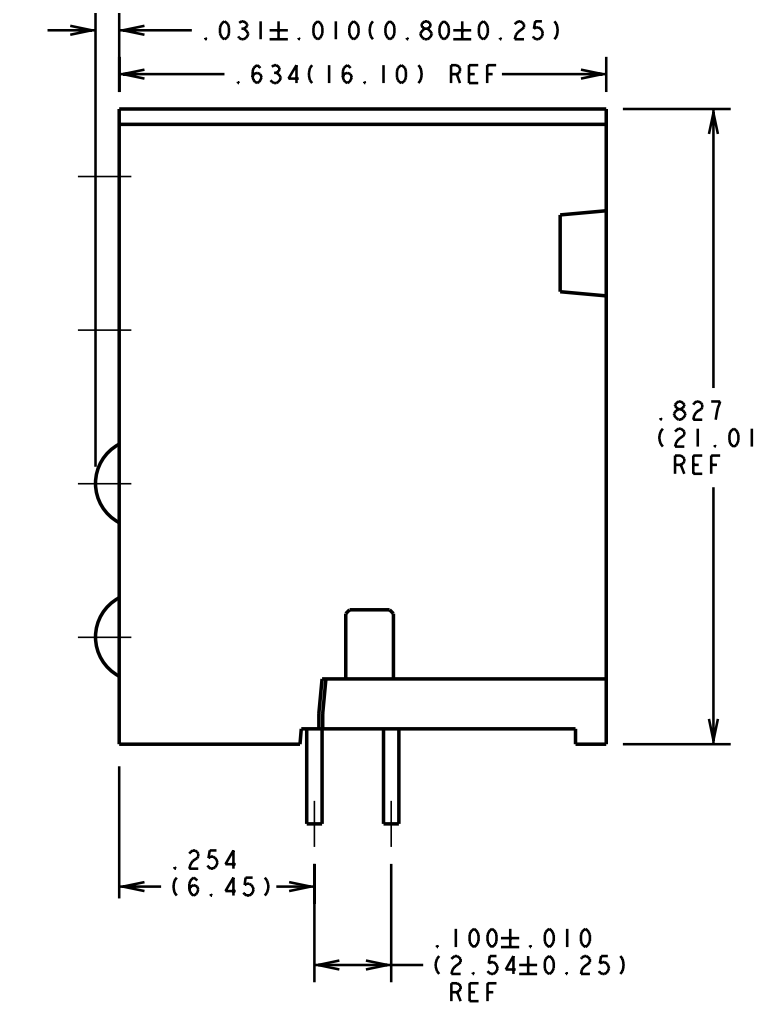

LED COLOR							
POS #	COLOR	POS #	COLOR	POS #	COLOR	POS #	COLOR
1	-BLANK-	5	-BLANK-	9	-BLANK-	13	-BLANK-
2	-BLANK-	6	-BLANK-	10	-BLANK-	14	-BLANK-
3	-BLANK-	7	-BLANK-	11	-BLANK-	15	YELLOW
4	SEE NOTE 3	8	-BLANK-	12	-BLANK-	16	YELLOW

YELLOW LED SPEC					
OPERATING CHARACTERISTICS AT 25° C AMBIENT					
LED CHARACTERISTICS	MIN.	TYP.	MAX.	UNITS	TEST CONDITIONS
LUMINOUS INTENSITY	7.4	10.0		mc d	I _F = 10 mA
FORWARD VOLTAGE		2.1	2.8	V	I _F = 20 mA
PEAK EMISSION WAVELENGTH		585		nm	
REVERSE CURRENT			100	µA	@ V _R = 5 V
VIEWING ANGLE (2 Ø 1/2)		60		DEGREES	
CAPACITANCE		15		pF	V _R = 0 V, f = 1 MHz

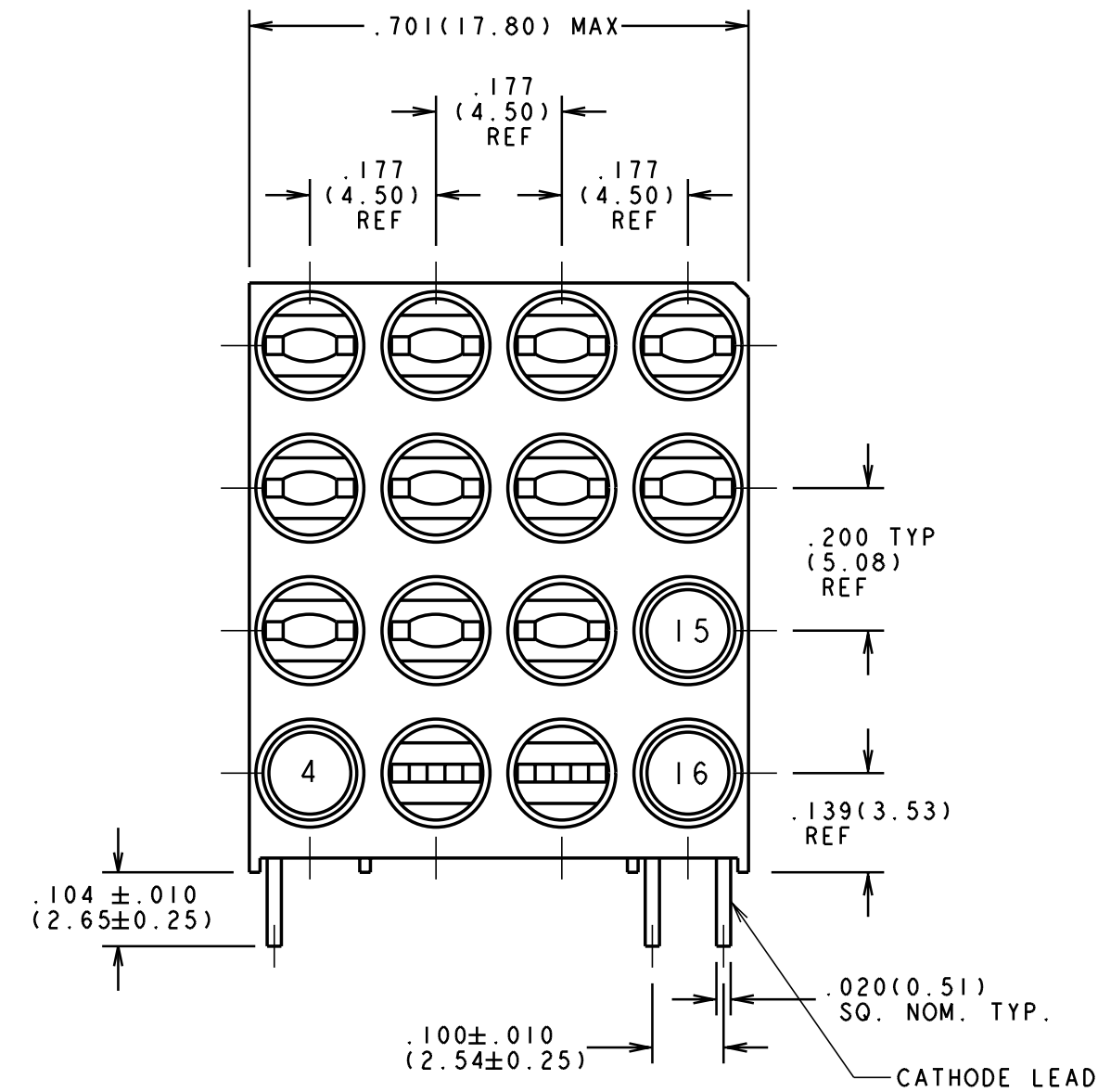
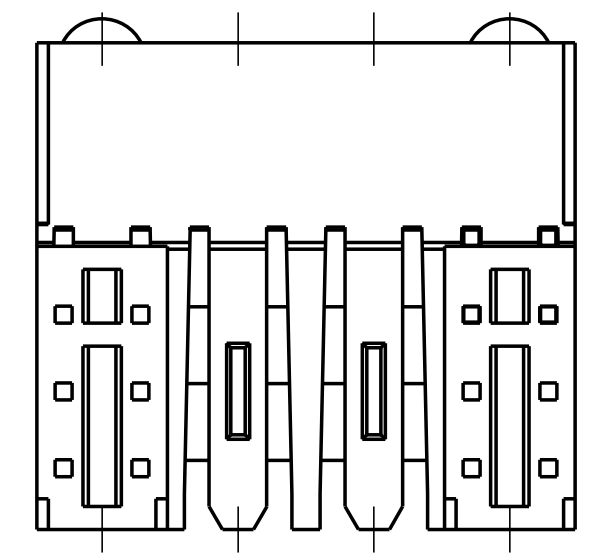

- NOTES :
- 3-COM PART NUMBER = 7320-455-009 REF
 - ALL DIMENSIONS ARE IN INCHES (mm)
 - YELLOW LED USED (NON-FUNCTIONAL) WITH ONLY 1 LEAD PROTUDING FROM BOTTOM OF HOUSING FOR ALIGNMENT PURPOSE
 - PACKAGING = BLOCKS PLACED IN CLEAR ANTISTATIC TRAY 80 BLOCKS PER TRAY
 - DIALIGHT PART NUMBER = 568-0016-804

THIS DRAWING AND THE CONTENTS HEREIN ARE CONFIDENTIAL AND THE SOLE PROPERTY OF DIALIGHT. REPRODUCTION OF THIS DRAWING OR CONSTRUCTION OF ANY PARTS WITHIN THIS DRAWING ARE FORBIDDEN WITHOUT THE WRITTEN CONSENT OF DIALIGHT.		
SCALE 4:1	DRAWING NUMBER	REV
TOLERANCES: UNLESS OTHERWISE SPECIFIED	C-16319	E
FRACTIONS: ±1/64	TITLE (4x4) CBI BLOCK	
DECIMALS (.XX): ±.020	MATERIAL	
DECIMALS (.XXX): ±.015	Dialight 1913 ATLANTIC AVE. MANASQUAN, N.J. 08736	
ANGLES: ±1°	SHEET OF FAMILY TABLES:	
FINISH:	FSCM 83330	