

CONNECTOR SUB-ASSEMBLY  
70929-2000 (PLUG SHOWN)  
71691-0003 (RECEPTACLE)  
PURCHASE SEPARATELY  
(REFER TO SALES  
DRAWING NUMBERS  
SDA-70929-20\*\* AND  
SDA-71691-0003)

CLAMP SHELL  
LOWER HALF

**NOTES:**

1. PLATING: 100 MICRONS MINIMUM BRIGHT NICKEL OVER COPPER FLASH (OPTIONAL).
2. CLAMP SHELLS TO BE PACKAGED PER PK-71245-001.
3. REFER TO APPLICATION SPECIFICATIONS AS-71691-9999 AND PS-70929.

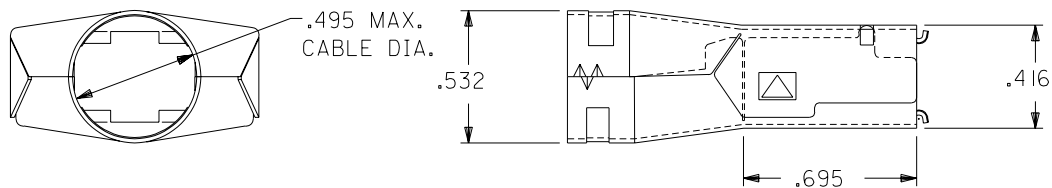

NOTE FOR LEAD FREE CONVERSION:  
THE PRIMARY SHIPPING CARTON WILL BE LABELED "COMPLIANT TO ROHS DIRECTIVE 2002/95/EC AND ELV ANNEX II OF DIRECTIVE 2000/53/EC". CARTONS WITHOUT THIS LABEL MAY CONTAIN PRODUCT WITH LEAD.

VIEWS SHOW CLAMPSHELLS IN ASSEMBLED  
(SEE NOTE #2)

B	LEADFREE ECN# UCP2004-1998 DMORGAN 04/04/21
A2	ADDED PK SPEC. UDT2000-0654 SCHMIDGA 00/01/12
A1	ADDED CONN. NO. PER ECN U6-0322 DRS 09/06/95
A	FIRST RELEASE PER ECN# U4-0550 MOS 5/18/94

MFG. SH. REV. LTR. REVISIONS

DIMENSIONS SHOWN (METRIC) INCH UNLESS OTHERWISE SPECIFIED TOLERANCES: ANGULAR ± 1/2°		▽ = 0 ▼ = 0		REVISE ONLY ON CAD SYSTEM													
<table border="1"> <thead> <tr> <th></th> <th>INCH</th> <th>METRIC</th> </tr> </thead> <tbody> <tr> <td>3 PLACE</td> <td>± .015</td> <td>---</td> </tr> <tr> <td>2 PLACE</td> <td>±</td> <td>±</td> </tr> <tr> <td>1 PLACE</td> <td>---</td> <td>±</td> </tr> </tbody> </table>			INCH	METRIC	3 PLACE	± .015	---	2 PLACE	±	±	1 PLACE	---	±	TITLE CLAMPSHELL KIT .050" @ 60 CKT LFH I/O .495 MAX. CABLE EXIT DIA.			
	INCH	METRIC															
3 PLACE	± .015	---															
2 PLACE	±	±															
1 PLACE	---	±															
DRAFT WHERE APPLICABLE MUST REMAIN WITHIN DIMENSIONS		molex MOLEX INCORPORATED LISLE, ILL. 60532 U.S.A.		SHEET NO. DATE 1 OF 1 05/18/94													
DRWG. BY: MOS		CHK'D. BY: BIXLER		PART NO. 71245-3000													
APP'D. BY: BIXLER		SCALE: 2:1		DRWG. NO. SDMS-71245-3000													
FILE NAME: 71245S2 DGN		THIS DRAWING CONTAINS INFORMATION THAT IS PROPRIETARY TO MOLEX INC. AND SHOULD NOT BE USED WITHOUT WRITTEN PERMISSION.		DIV. SIZE CD B													