

| DASH NO | MODEL NO | IMPD OHMS | A DIM |
|---------|----------|-----------|-------|
| -1 | BJ120 | 50 | .055 |
| -2 | UBJ120 | 75 | .025 |

| INCH | MM |
|------|-------|
| .005 | 0.13 |
| .025 | 0.64 |
| .030 | 0.76 |
| .055 | 1.40 |
| .120 | 3.05 |
| .150 | 3.81 |
| .317 | 8.05 |
| .450 | 11.43 |
| .550 | 13.97 |
| .875 | 22.22 |

| REVISIONS | | | 1005-0455 | SH 1 | |
|-----------|------|------------------------|-----------|--------------------|---------|
| REV | EO | DESCRIPTION | DWN | APPROVED | DATE |
| A | 2462 | MOD WAS JACK, PUSH ON | POB | <i>[Signature]</i> | 9-20-74 |
| B | 4012 | -2 WAS BASIC, ADDED -1 | WJM | <i>[Signature]</i> | 11-1-77 |
| C | 4161 | 8005-0180-1 WAS BASIC | TAH | <i>[Signature]</i> | 4-10-78 |
| D | 7191 | ADDED .055 DIA | JSA | <i>[Signature]</i> | 9-18-86 |

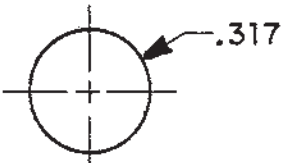

RECOMMENDED
PANEL CUTOUT
SCALE: 2/1

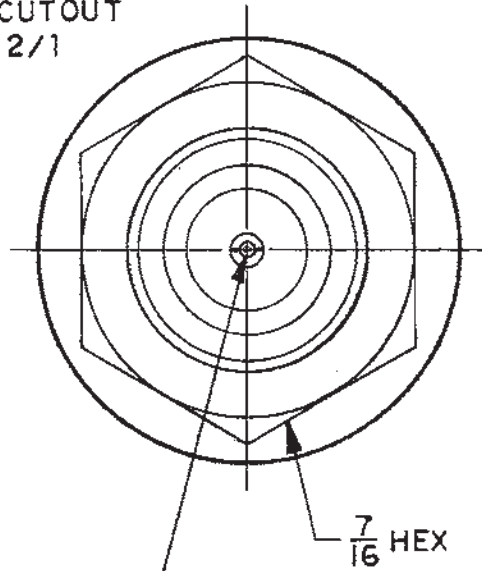

SOLDER POT ACCEPTS
A DIA WIRE

4. PANEL THK .120 MAX
3. FEMALE COAXIAL PUSH ON TYPE BULKHEAD JACK BOTH 50 & 75 OHM VERSIONS (BNC SIZE)
2. FINISH: TFS-1A (NICKEL)
1. ALL DIM ARE IN INCHES

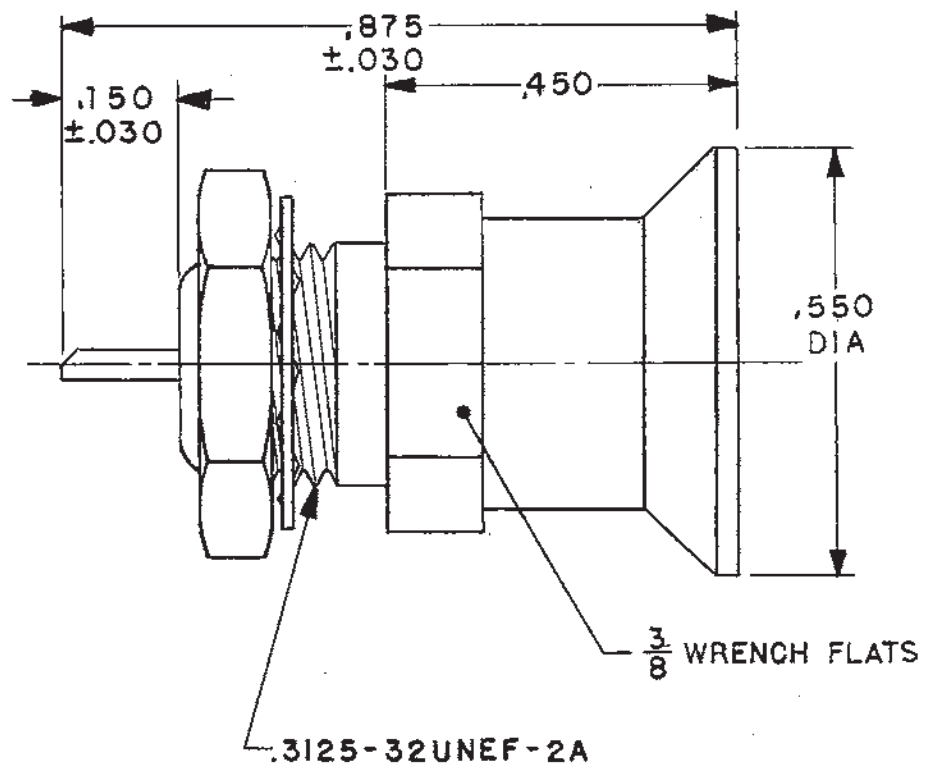

| QTY | DESCRIPTION | PART NUMBER | ITEM | | |
|---|----------------------------|------------------|-------|--------------|--------------|
| TOL UNLESS SPECIFIED .XX ± .XXX ±.005 .XXX ± ANGLES ± | | BJ120/UBJ120 | | | |
| DWN | JKR 9-6-73 | | | MATERIAL | CODE IDENT |
| CHK | <i>[Signature]</i> 10-5-73 | — | 14949 | 1005-0455 | D |
| ENGR | <i>[Signature]</i> 10-9-73 | SCALE 4/1 | | DATE 10-9-73 | SHEET 1 OF 2 |
| APPR | <i>[Signature]</i> 10/9/73 | | | | |

NEXT ASSY