

LOADING PATTERN MATING SIDE

f	0	0	0	0	0	0	0	0	0	0
e	4	0	4	0	4	0	4	0	4	0
d	4	0	4	0	4	0	4	0	4	0
c	4	0	4	0	4	0	4	0	4	0
b	4	0	4	0	4	0	4	0	4	0
a	4	0	4	0	4	0	4	0	4	0
z	0	0	0	0	0	0	0	0	0	0
P	0									
S	1				5				1	0

LOADED CONNECTOR ASSEMBLY
(FOR EXAMPLE)

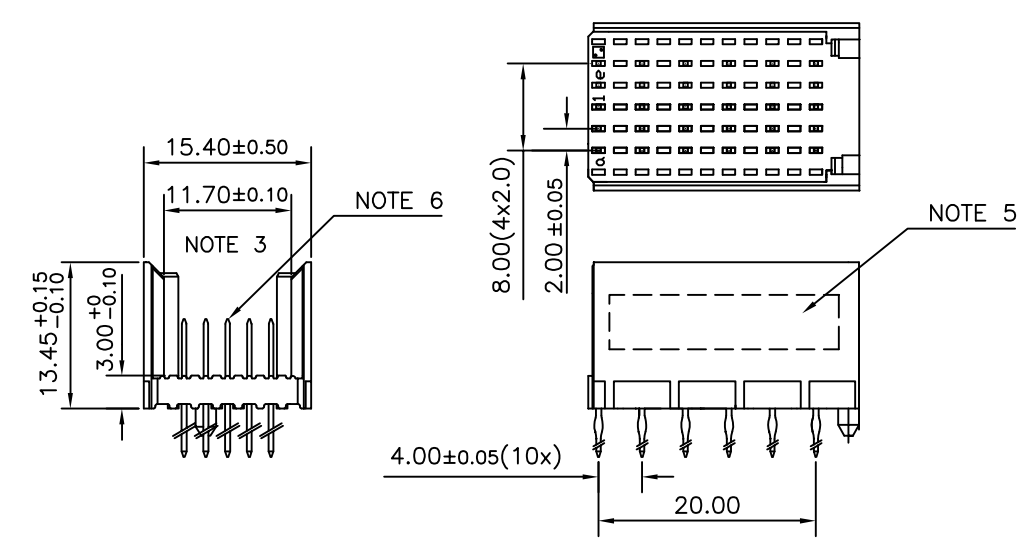

CONTACT OVERVIEW

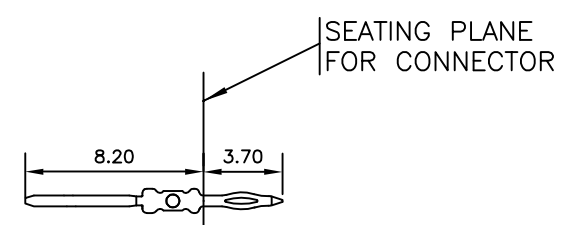

LAY-OUT P.C.B.-HOLE

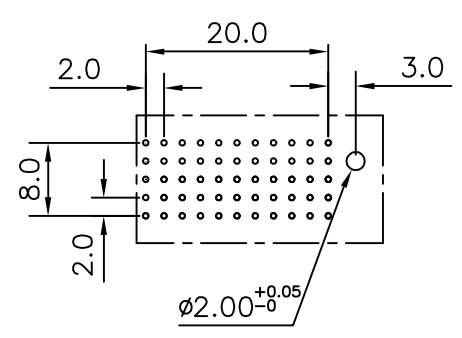

HM2P09PD5310 LEAD FREE INDICATOR : LF = LEAD FREE (DIGIT 15 & 16)
 PLATING CODE (DIGIT 13 AND 14) (REF DRW NO. BS,C , 201844 , 003)

NOTES

- THIS PRODUCT IS CSA APPROVED.
 - THIS PRODUCT IS UL RECOGNIZED.
 - MEASURED AT THE BOTTOM.
 - MATERIAL CONTACT: PHOSPHORBRONZE
HOUSING: CREAM WHITE GLASS FILLED POLYESTER UL-94V0
 - CONNECTOR PRINTED WITH P/N AND DATE CODE.
 - FOR ACTUAL CONTACT LOADINGS, SEE LOADING PATTERN MATING SIDE.
 - SHAPE OF CONNECTOR HOUSING CAN ALTER DEPENDING ON PRODUCTION LOCATION
 - THE PRODUCT (LF) MEETS EUROPEAN UNION DIRECTIVES AND OTHER COUNTRY REGULATIONS AS DESCRIBED IN GS-22-008
 - FOR RECOMMENDED PTH DIMENSIONS REFER DRAWING : BS, A , 201572 , 001
- CATALOG NO: HM2P09PD5310----

mat'l. code SEE NOTE 4				surface ISO 1302 <input checked="" type="checkbox"/>		tolerance ISO 406 ISO 1101		projection 		product family MILLIPACS			
litr				ecn no		dr		date		tolerances unless otherwise specified			
A				I05-0247		MINI		2005-12-07		angles		linear	
B				I06-0132		MINI		2006-07-31		0°±1°		scale -	
										dr		MINI K VANDANATH 2005-12-07	
										enr		BIJU K PAUL 2005-12-07	
										chr		BIJU K PAUL 2006-07-31	
										appd		BIJU K PAUL 2006-07-31	
sheet index		revision sheet		B		1							
										dwg no		sheet 1 of 1 size 5	
										BS, C , 203028,530		A3	
										type		Product Customer Drawing	



Copyright FCI