

PART NUMBER	REV	TERMINATOR	FEED TYPE	DESCRIPTION
1426572-1	A	LEADMAKER	MECH POST FEED	CUTS CARRIER
1426572-2	A	BENCH	MECH PRE FEED	CUTS CARRIER
1426572-6	A	LEADMAKER	MECH POST FEED	CONTINUOUS CARRIER
7-1426572-1	A	LEADMAKER	MECH POST FEED	-1 AND SPARE PARTS
7-1426572-2	A	BENCH	MECH PRE FEED	-2 AND SPARE PARTS
7-1426572-6	A	LEADMAKER	MECH POST FEED	-6 AND SPARE PARTS
7-1426572-7	A	-	-	SPARE PARTS KIT

CRIMP DATA		ESCUBEDO TERMINAL		TYCO CRIMP SPECS	
TERMINAL NAME: TERMINAL HEMBRA Serie 2.3					
CRIMP	SIZE	TYPE	RANGE		
WIRE	1.78 [.070 IN]	F	0.50mm ² - 1.25mm ²		
INSUL	4.32 [1.70 IN]	o	3.40 [1.34 IN]		
WIRE STRIP LENGTH 4.30-4.70 [1.70-1.85 IN]		APPL INSTRUCTIONS 408-8322			
TERMINAL APPL SPEC		FEED		9.65 [3.80 IN]	
TERMINALS APPLIED					
TYCO PN	MANUF'S PN	TYCO SEAL PN	MANU'S SEAL PN		
1572839-1	4452.01	1572859-1	51212		
1572839-2	4452.31	1572860-1	7165-0473		
1572839-3	4452.30	-	-		
1572839-4	4452.00	-	-		
WIRE SIZE	CRIMP HEIGHT	PINPN & LENGTH [IN]			
1.25mm ²	1.47 ± 0.05 [.058 ± .002 IN]	9-354778-9 [.2990]			
1.00mm ²	1.37 ± 0.05 [.054 ± .002 IN]	354779-9 [.3035]			
0.75mm ²	1.24 ± 0.05 [.049 ± .002 IN]	2-354779-0 [.3090]			
0.50mm ²	1.14 ± 0.05 [.045 ± .002 IN]	2-354779-8 [.3130]			

- △ RECOMMENDED SPARE PARTS.
- 2. GREASE RAM, CAM, CAM FOLLOWER AND FEED ROD LIGHTLY.
- 3. LUBRICATE DAILY PER THE APPLICATOR INSTRUCTION SHEET SUPPLIED WITH THE APPLICATOR.
- △ THIS APPLICATOR APPLIES TERMINAL WITH A SEAL. INSULATION DIA QUOTED IS OUTSIDE DIAMETER OF SEAL.
- △ APPLY TORO-SEAL IN ALLEN SOCKET TO FILL HOLE AFTER FLAT HD HAS BEEN ADJUSTED TO CORRECT HEIGHT AT QUALIFICATION. APPLY #1-23419-5 LOC-TITE TO THREADS.
- △ ALL CRIMP DATA CALCULATED BY TYCO ELECTRONICS.

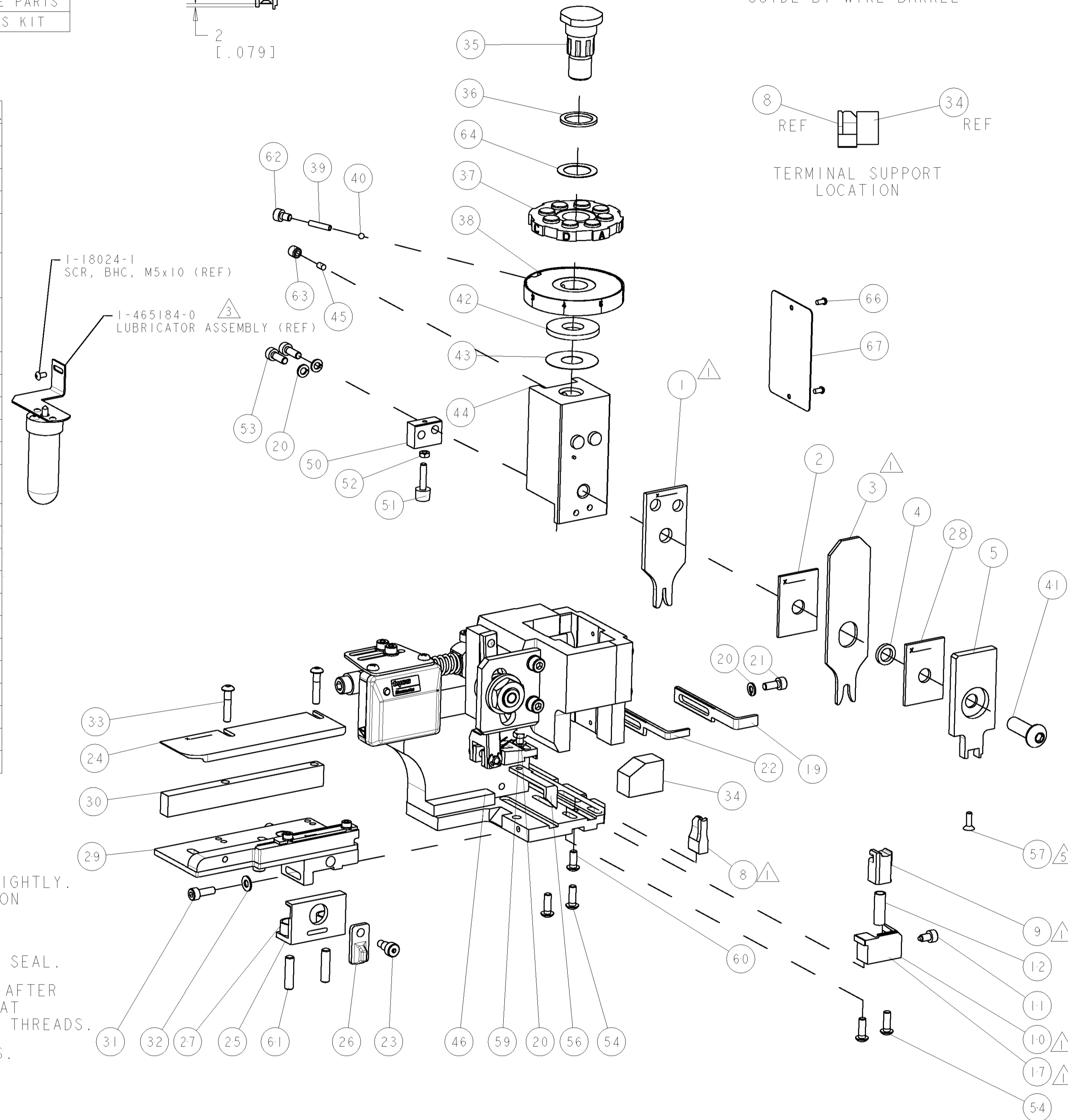
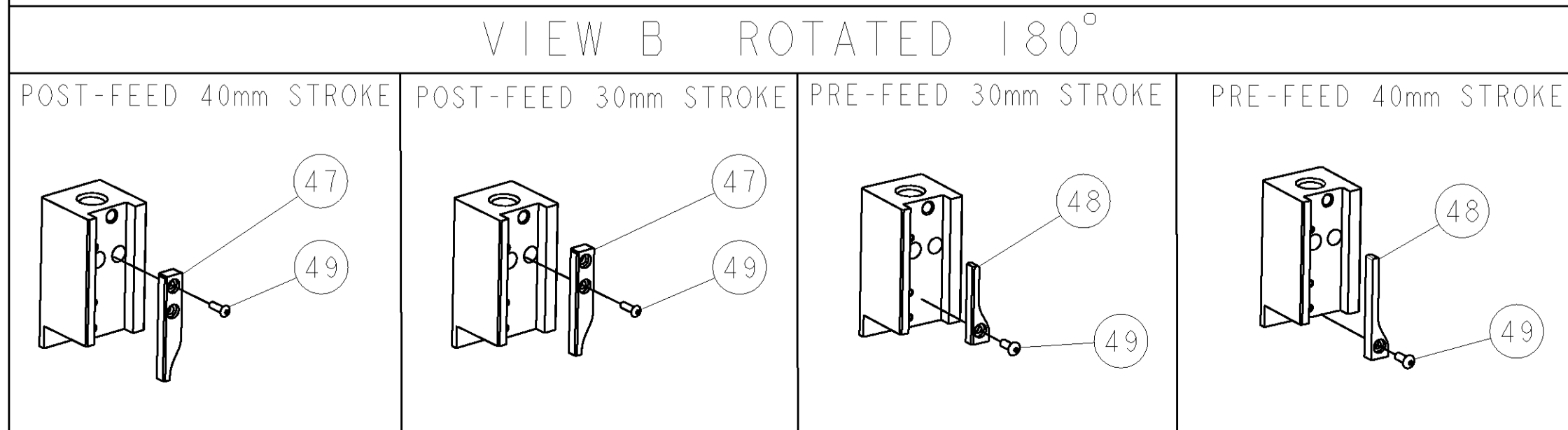

-77	-76	-72	-71	-6	-2	-1	PART NO	DESCRIPTION	ITEM NO
-	-	-	-	-	-	-	-	-	83
-	-	-	-	-	-	-	-	-	82
-	-	-	-	-	-	-	-	-	81
-	-	-	-	-	-	-	-	-	80
-	-	-	-	-	-	-	-	-	79
-	-	-	-	-	-	-	-	-	78
-	-	-	-	-	-	-	-	-	77
-	-	-	-	-	-	-	-	-	76
-	-	-	-	-	-	-	-	-	75
-	-	-	-	-	-	-	-	-	74

SET UP GAGE 458637-3		LOC	DIST	REVISIONS					
P	LTR	DESCRIPTION	DATE	DWN	APVD				
A	66	SEE ECO-05-015626	03JAN2006	DP	MC				
-	-	-	-	-	-	-	73		
-	-	-	-	-	-	-	72		
-	-	-	-	-	-	-	71		
-	-	-	-	-	-	-	70		
-	-	-	-	-	-	-	69		
-	-	-	-	-	-	-	68		
-	-	-	-	-	-	-	67		
-	-	-	-	-	-	-	66		
-	-	-	-	-	-	-	65		
-	-	-	-	-	-	-	64		
-	-	-	-	-	-	-	63		
-	-	-	-	-	-	-	62		
-	-	-	-	-	-	-	61		
-	-	-	-	-	-	-	60		
-	-	-	-	-	-	-	59		
-	-	-	-	-	-	-	58		
-	-	-	-	-	-	-	57		
-	-	-	-	-	-	-	56		
-	-	-	-	-	-	-	55		
-	-	-	-	-	-	-	54		
-	-	-	-	-	-	-	53		
-	-	-	-	-	-	-	52		
-	-	-	-	-	-	-	51		
-	-	-	-	-	-	-	50		
-	-	-	-	-	-	-	49		
-	-	-	-	-	-	-	48		
-	-	-	-	-	-	-	47		
-	-	-	-	-	-	-	46		
-	-	-	-	-	-	-	45		
-	-	-	-	-	-	-	44		
-	-	-	-	-	-	-	43		
-	-	-	-	-	-	-	42		
-	-	-	-	-	-	-	41		
-	-	-	-	-	-	-	40		
-	-	-	-	-	-	-	39		
-	-	-	-	-	-	-	38		
-	-	-	-	-	-	-	37		
-	-	-	-	-	-	-	36		
-	-	-	-	-	-	-	35		
-	-	-	-	-	-	-	34		
-	-	-	-	-	-	-	33		
-	-	-	-	-	-	-	32		
-	-	-	-	-	-	-	31		
-	-	-	-	-	-	-	30		
-	-	-	-	-	-	-	29		
-	-	-	-	-	-	-	28		
-	-	-	-	-	-	-	27		
-	-	-	-	-	-	-	26		
-	-	-	-	-	-	-	25		
-	-	-	-	-	-	-	24		
-	-	-	-	-	-	-	23		
-	-	-	-	-	-	-	22		
-	-	-	-	-	-	-	21		
-	-	-	-	-	-	-	20		
-	-	-	-	-	-	-	19		
-	-	-	-	-	-	-	18		
-	-	-	-	-	-	-	17		
-	-	-	-	-	-	-	16		
-	-	-	-	-	-	-	15		
-	-	-	-	-	-	-	14		
-	-	-	-	-	-	-	13		
-	-	-	-	-	-	-	12		
-	-	-	-	-	-	-	11		
-	-	-	-	-	-	-	10		
-	-	-	-	-	-	-	9		
-	-	-	-	-	-	-	8		
-	-	-	-	-	-	-	7		
-	-	-	-	-	-	-	6		
-	-	-	-	-	-	-	5		
-	-	-	-	-	-	-	4		
-	-	-	-	-	-	-	3		
-	-	-	-	-	-	-	2		
-	-	-	-	-	-	-	1		
-77	-76	-72	-71	-6	-2	-1	PART NO	DESCRIPTION	ITEM NO

DIMENSIONS: mm [IN]	TOLERANCES UNLESS OTHERWISE SPECIFIED:	DWN: PROUSE 31OCT2005	APVD: MCLIFFORD 31OCT2005	NAME: MCLIFFORD	PRODUCT SPEC:	SIZE: A	CAGE CODE: 00779	DRAWING NO: C=1426572	RESTRICTED TO:
0 PLC ±	1 PLC ±	2 PLC ±	3 PLC ±	4 PLC ±	ANGLES ±	FINISH	WEIGHT	CUSTOMER DRAWING	SCALE: 3:5