

PLEASE CHECK WWW.MOLEX.COM FOR LATEST PART INFORMATION

Part Number: [19085-0004](#)
Status: **Active**
Overview: Ring Tongue - Spade Terminals
Description: Open Barrel Ring , Tin-Plated Brass, for 14-18 AWG Wire, Stud Size 6 (M3.5)

Documents:

[Drawing \(PDF\)](#) [Product Specification PS-19902-011 \(PDF\)](#)
[Product Specification PS-19902-006 \(PDF\)](#) [RoHS Certificate of Compliance \(PDF\)](#)

Agency Certification

CSA LR18689
 UL E32244

General

Product Family Ring and Spade Terminals
 Series [19085](#)
 Crimp Quality Equipment Yes
 Mil-Spec N/A
 Overview [Ring Tongue - Spade Terminals](#)
 Product Name N/A
 Type Ring
 UPC 800755080285

Physical

Barrel Type Open
 Insulation None
 Material - Plating Mating Tin
 Net Weight 0.851/g
 Packaging Type Reel
 Plating min - Mating 5.080µm
 Plating min - Termination 5.080µm
 Stud Size 6 (M3.5)
 Temperature Range - Operating 149°C
 Termination Interface: Style Crimp or Compression
 Wire Insulation Diameter N/A
 Wire Size AWG 14, 16, 18
 Wire Size mm² 0.80 - 2.00

Electrical

Voltage - Maximum 2000V

Material Info

Old Part Number RZ-4129-06

Reference - Drawing Numbers

Product Specification PS-19902-006, PS-19902-011
 Sales Drawing SD-19085-002

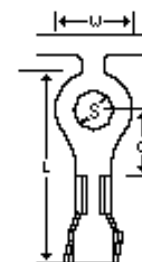

Series

image - Reference only

EU RoHS

**ELV and RoHS
Compliant**

REACH SVHC

**Contains SVHC: No
Low-Halogen Status
Not Reviewed**

China RoHS



**Need more information on product
environmental compliance?**

Email productcompliance@molex.com
 For a multiple part number RoHS Certificate of Compliance, [click here](#)

Please visit the [Contact Us](#) section for any non-product compliance questions.

Search Parts in this Series

19085Series

Application Tooling | FAQ

Tooling specifications and manuals are found by selecting the products below. Crimp Height Specifications are then contained in the Application Tooling Specification document.

Global

Description	Product #
ASP Perishable Tool Kit used in ASP presses that process metal strip product	0190290053
Mini-Mac™ Applicator	0638815600