

THIS IS A C.A.D. GENERATED DRAWING
DO NOT MAKE MANUAL REVISIONS TO MASTER.

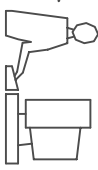

ISSUE NUMBER
REMOVE INSULATOR DIMPLES
R.STA.MONICA APR.09/2012

3

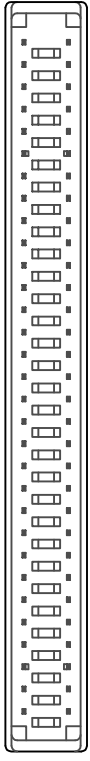
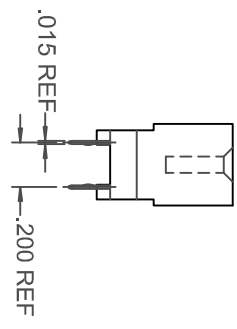
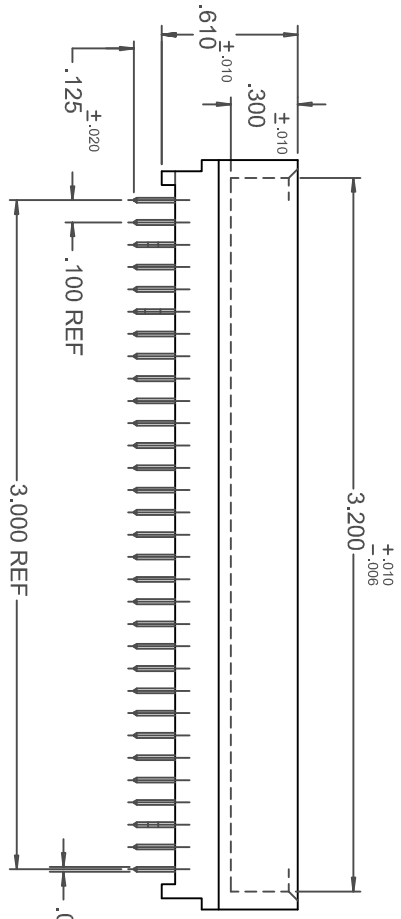
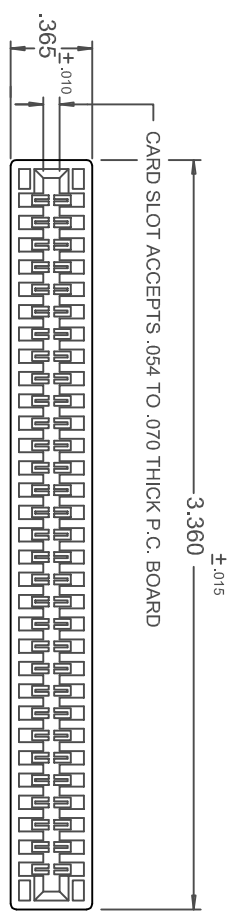

SPECIFICATIONS

MATERIAL SPECIFICATIONS

- 1) CONTACT MATERIAL: PHOSPHOR BRONZE.
- 2) CONTACT FINISH: 50 MICROINCHES OF NICKEL FOLLOWED BY GOLD ON THE MATING AREA AND 100 MICROINCHES OF TIN ON THE CONTACT TAILS
- 3) INSULATOR MATERIAL: THERMOPLASTIC POLYESTER GLASS FIBRE REINFORCED, NON-FLAMMABLE (UL94-V0). COLOR BLACK

ELECTRICAL SPECIFICATIONS

- 1) CURRENT RATING: 3 AMPERES.
- 2) CONTACT RESISTANCE: 16 MILLIOHMS MAXIMUM.
- 3) INSULATION RESISTANCE: 5,000 MEGOHMS MIN.
- 4) OPERATING TEMPERATURE: -40° C TO +105° C.

MECHANICAL SPECIFICATIONS

- 1) THE CARD SLOT WILL ACCEPT P.C. BOARDS FROM .054" TO .070" THICK.
- 2) INSERTION FORCE: 10 OUNCES MAXIMUM PER CONTACT PAIR WITH A .070" STEEL GAUGE.
- 3) WITHDRAWAL FORCE: 1.0 OUNCES MINIMUM PER CONTACT PAIR WITH A .054" STEEL GAUGE.
- 4) CONTACT RETENTION: CONTACTS MAY WITHSTAND AN AXIAL PUSHOUT FORCE OF 4 POUNDS WITHOUT ANY DAMAGE TO THE CONNECTOR.



THIS SERIES FULLY CONFORMS TO THE
EUROPEAN UNION DIRECTIVES 2002/95/EC
AND 2002/96/EC FOR ROHS COMPLIANCY.

TOLERANCE UNLESS NOTED	±.005
	.000

**395-062-520-350
CARD EDGE CONNECTOR**

EDAC INC
TORONTO, ONTARIO
CANADA
YOUR CONNECTION TO QUALITY & SERVICE

THESE DRAWINGS AND SPECIFICATIONS ARE THE PROPERTY OF EDAC INC. AND SHALL NOT BE REPRODUCED OR COPIED OR USED AS THE BASIS FOR THE MANUFACTURE OR SALE OF APPARATUS WITHOUT WRITTEN PERMISSION.

ACAD REF. DWG. NUMBER:	395-062-520-350
DRAWN: R.BLAKELEY	DATE: OCT. 01/04
CHECKED:	DATE:
SCALE:	SHEET 1 OF 1
DRAWING NUMBER	ISSUE
395-062-520-350	3