

| MATERIAL NUMBER | ENGINEERING NUMBER | FITS MALE TAB SIZE | "A" MAX. | "C" MAX. | "E" MAX. | CARRIER CONFIGURATION |
|-----------------|--------------------|--------------------|----------|-----------|-----------|-----------------------|
| 190030126 | AA-2202V | .187X.020 | .78/19.8 | .316/8.03 | .160/4.06 | LOOSE PIECE |
| 190030127 | AA-2202VT | .187X.020 | .78/19.8 | .316/8.03 | .160/4.06 | TAPE MOUNT |
| 190030128 | AA-2202VC | .187X.020 | .78/19.8 | .316/8.03 | .160/4.06 | PLASTIC STRIP |
| 190030129 | AA-2203V | .187X.032 | .78/19.8 | .316/8.03 | .160/4.06 | LOOSE PIECE |
| 190030130 | AA-2203VT | .187X.032 | .78/19.8 | .316/8.03 | .160/4.06 | TAPE MOUNT |
| 190030131 | AA-2203VC | .187X.032 | .78/19.8 | .316/8.03 | .160/4.06 | PLASTIC STRIP |
| 190030005 | AA-220IVN | .250X.032 | .86/21.8 | .380/9.65 | .180/4.57 | LOOSE PIECE |
| 190030007 | AA-220IVNT | .250X.032 | .86/21.8 | .380/9.65 | .180/4.57 | TAPE MOUNT |
| 190030111 | AA-220IVNC | .250X.032 | .86/21.8 | .380/9.65 | .180/4.57 | PLASTIC STRIP |

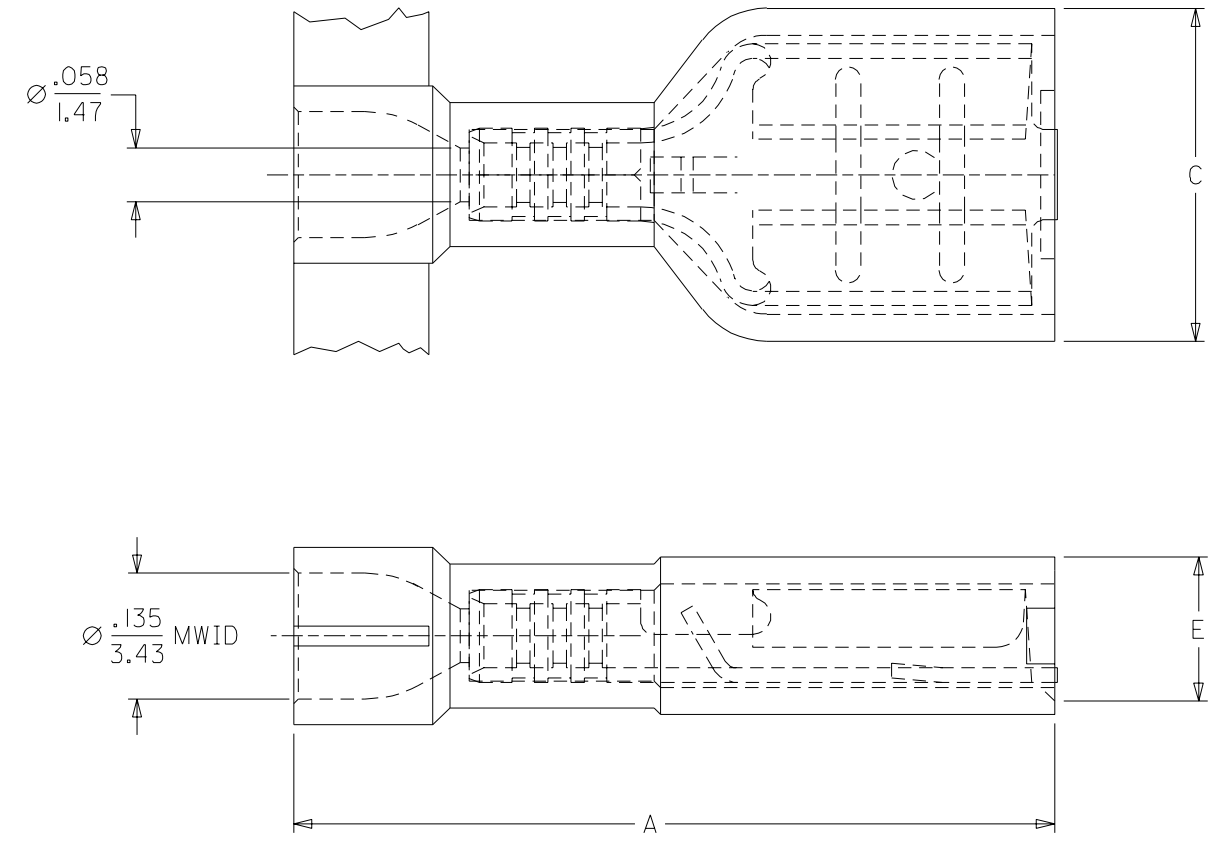

- NOTES:
- ① MATERIAL: TERMINAL: BRASS .016/0.41.
PLATING: ELECTRO-TIN
INSULATION: NYLON 6/6 94V-0 RATING
COLOR: RED
 - 2. MWID = MAXIMUM WIRE INSULATION DIAMETER.
 - 3. ALL DIMENSIONS = INCHES/MM

SALES DRAWING

| | | | | | | | | | |
|---|---|--|------------|------------------------------------|--|---|---|-----|-----------|
| REV'D NYLON COLOR EC NO. ETC2004-0101 DRWN: BRE 03/11/21 CHK: HEB 03/11/21 APPR: RWD 03/11/21 | QUALITY SYMBOLS MAJOR $\blacktriangle = 0$ CRITICAL $\triangle = 0$ | GENERAL TOLERANCES: (UNLESS SPECIFIED) | | SCALE NO: NE | DESIGN UNITS <input type="checkbox"/> mm <input checked="" type="checkbox"/> INCH | THIRD ANGLE PROJECTION <input checked="" type="checkbox"/> THIRD ANGLE <input type="checkbox"/> FIRST ANGLE | DIMENSIONS: <input type="checkbox"/> mm <input checked="" type="checkbox"/> INCH <input type="checkbox"/> mm ONLY | SHT | REV |
| | | 4 PLACES $\pm 0.---$ | $\pm .---$ | DRAWN BY & DATE HEB 01/06/07 | | TITLE: FIQD FEMALE, INSULKRIMP 94V-0 MATERIAL 22-18 AWG | | | |
| | | 3 PLACES $\pm 0.---$ | $\pm .005$ | CHECKED BY & DATE RWD 01/06/07 | | | | | |
| | | 2 PLACES ± 0.13 | $\pm .01$ | APPROVED BY & DATE RWD 01/06/07 | | MOLEX INCORPORATED | | | |
| 1 PLACE ± 0.25 | $\pm .---$ | CAD FILENAME S19003001.DGN | | MATERIAL NO. SEE TABLE | DRAWING NO. SD-19003-001 | | | | |
| ANGULAR: $\pm 1/2^\circ$ | | DRAFT WHERE APPLICABLE MUST REMAIN WITHIN DIMENSIONS | | | THIS DRAWING CONTAINS INFORMATION THAT IS PROPRIETARY TO MOLEX INCORPORATED AND SHOULD NOT BE USED WITHOUT WRITTEN PERMISSION. | | | | SIZE B |