

TYPICAL INDICATOR ORDERING EXAMPLE



| Models | |
|--------|----------------------------|
| 01 | Low .079" (2.0mm) Profile |
| 02 | High .291" (7.4mm) Profile |

| PC Terminals | |
|--------------|-----------------------|
| For 01 Model | |
| P | Straight |
| B | Straight with Bracket |
| H | Right Angle |
| V | Vertical |
| For 02 Model | |
| P | Straight |

| LED Colors | |
|------------|--------|
| C | Red |
| E | Yellow |
| F | Green |

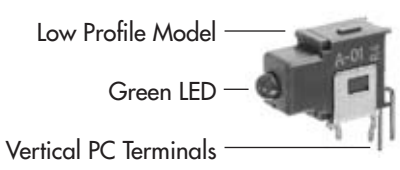

A01VF

DESCRIPTION FOR TYPICAL ORDERING EXAMPLES

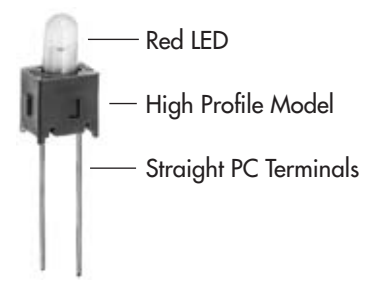

A02PC

PC TERMINALS

P Straight

B Straight with Bracket

H Right Angle

V Vertical

LED COLORS & SPECIFICATIONS

| Models | A01 Indicator | | | A02 Indicator | | |
|-----------------------------------|---------------|-----------|-----------|---------------|-----------|-----------|
| | C | E | F | C | E | F |
| LED is colored in OFF state | Red | Yellow | Green | Red | Yellow | Green |
| Maximum Forward Current | 50mA | 50mA | 50mA | 25mA | 30mA | 30mA |
| Typical Forward Current | 30mA | 30mA | 30mA | 20mA | 20mA | 20mA |
| Forward Voltage | 1.7V | 2.2V | 2.1V | 2.1V | 2.1V | 2.2V |
| Maximum Reverse Voltage | 4V | 4V | 4V | 4V | 4V | 4V |
| Current Reduction Rate Above 25°C | 0.67mA/°C | 0.67mA/°C | 0.67mA/°C | 0.33mA/°C | 0.40mA/°C | 0.40mA/°C |
| Ambient Temperature Range | -30°C ~ +85°C | | | -30°C ~ +85°C | | |

Electrical specifications are determined at a basic temperature of 25°C.
 If the source voltage is greater than the LED's rated voltage, a ballast resistor must be connected in series with the LED.
 The ballast resistor value can be calculated by using the formula shown in the Supplement section.

Toggles
 Rockers
 Pushbuttons
 Illuminated PB
 Programmable
 Keylocks
 Rotaries
 Slides
 Tactiles
 Tilt
 Touch
 Indicators
 Accessories
 Supplement

TYPICAL INDICATOR DIMENSIONS

Straight PC

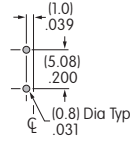
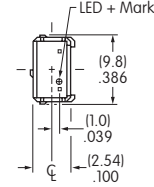
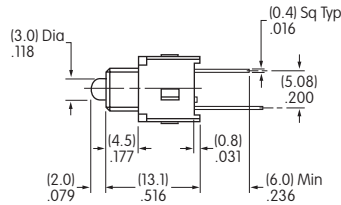
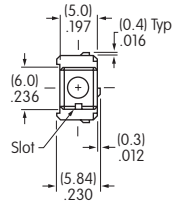

A01PF

Straight PC • Bracket

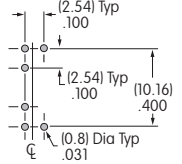
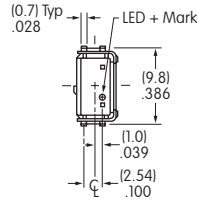
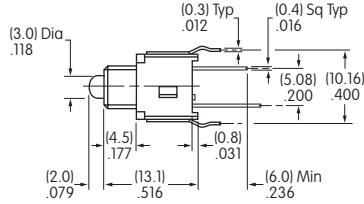
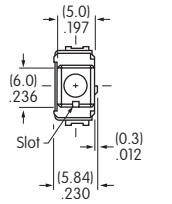

A01BF

Right Angle PC

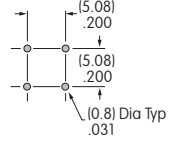
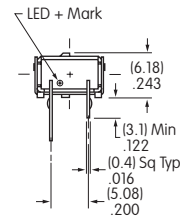
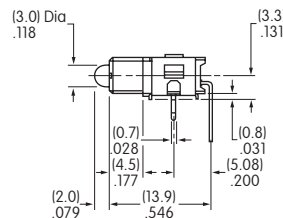
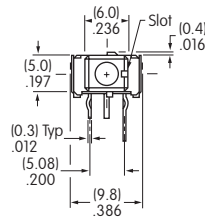

A01HF

Vertical PC

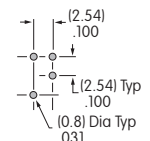
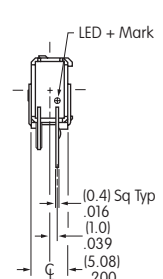
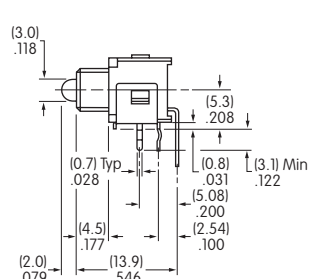
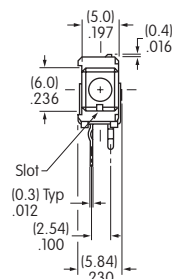

A01VF

Straight PC

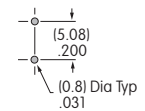
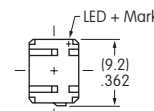
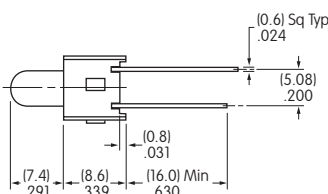
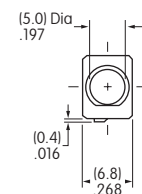

A02PF