

THIS DRAWING IS UNPUBLISHED. RELEASED FOR PUBLICATION
 © COPYRIGHT - By - ALL RIGHTS RESERVED.

LOC		DIST		REVISIONS			
GP	00	P	LTR	DESCRIPTION	DATE	DWN	APVD
		M		REVISED PER ECO-11-022157	16MAY2012	CJV	CWR

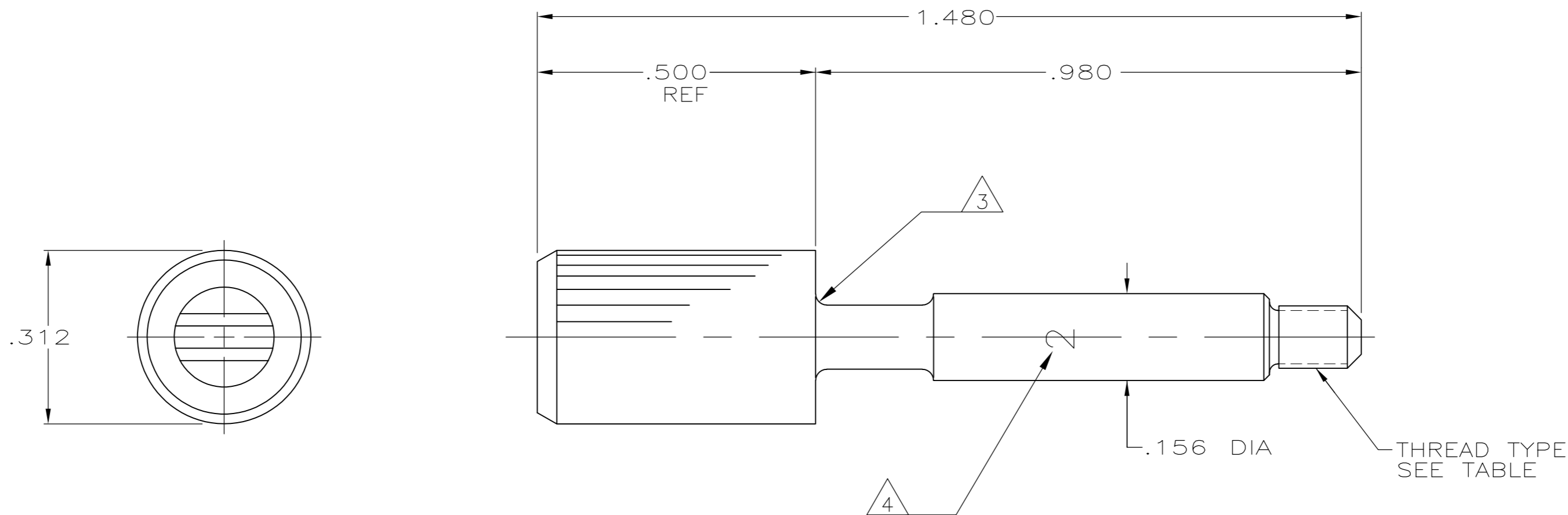

- ① ZINC DIE CAST PER ASTM B86.
- ② ELECTRODEPOSITED POLYURETHANE, BLACK.
- ③ COATING COVERAGE MAY BE INCOMPLETE IN THIS AREA.
- ④ CAVITY ID IN THIS AREA.

OBSOLETE	M2.6 X 0.45	748627-8
OBSOLETE	M3 X 0.5	748627-4
	#4-40	748627-2
	THREAD TYPE	PART NUMBER

THIS DRAWING IS A CONTROLLED DOCUMENT. DIMENSIONING AND TOLERANCING PER ASME Y14.5M-2009		DWN B. MCMASTER 26FEB04	TE Connectivity	
DIMENSIONS: INCHES		CHK C. ROHDE 26FEB04	NAME	
TOLERANCES UNLESS OTHERWISE SPECIFIED:		APVD M. WALMSLEY 26FEB04	JACKSCREW, LARGE HEAD, NON-MAGNETIC, SHIELDING ENCLOSURE, AMPLIMITE	
0 PLC ± -	1 PLC ± -	PRODUCT SPEC	SIZE	CAGE CODE
2 PLC ± -	3 PLC ± .005	APPLICATION SPEC	A2	00779
4 PLC ± -	ANGLES ± -	WEIGHT	C=748627	DRAWING NO
MATERIAL	FINISH	CUSTOMER DRAWING	SCALE	SHEET
①	②		5:1	1 of 1
			REV	M