

- 1 MATERIAL: CONNECTOR-NYLON UL94V-2.  
CONTACTS-0.30 [.012] THICK COPPER ALLOY  
0.00076 [.000030] GOLD OR 0.00076[.000030]  
TOTAL GOLD FLASH OVER PALLADIUM NICKEL,  
PER TE CONNECTIVITY'S DISCRETION, IN  
CONTACT AREA WITH BRIGHT TIN-LEAD  
FOR 641240-2 THRU 2-641240-8, MATTE  
WHISKER MITIGATED TIN FOR 3-641240-2  
THRU 5-641240-8 OVER NICKEL UNDERPLATE.
- 2 CONTACTS ACCEPT 28 AWG WIRE WITH 1.52 [.060] MAX INSULATION DIAMETER.
- 3 CONTACTS MUST ACCEPT 0.64±0.03 [.025±.001] SQUARE POST AND REMAIN LOCKED IN POSITION.
- 4 IDENTIFICATION NUMBER FOR LAST CIRCUIT MAY NOT APPEAR ON ALL ASSEMBLIES.
- 5 DIMENSIONS IN BRACKETS ARE IN INCHES.
- 6 HOUSING FEATURES ARE: CLOSED END WITH LOCKING RAMP.
- 7 OBSOLETE PARTS: OBSOLETE CIS STREAMLINING PER D.RENAUD/D.SINISI
- 8 GREEN COLOR STRIPE ON HOUSING (NOT SHOWN) MAY RUN DOWN BETWEEN RIBS.

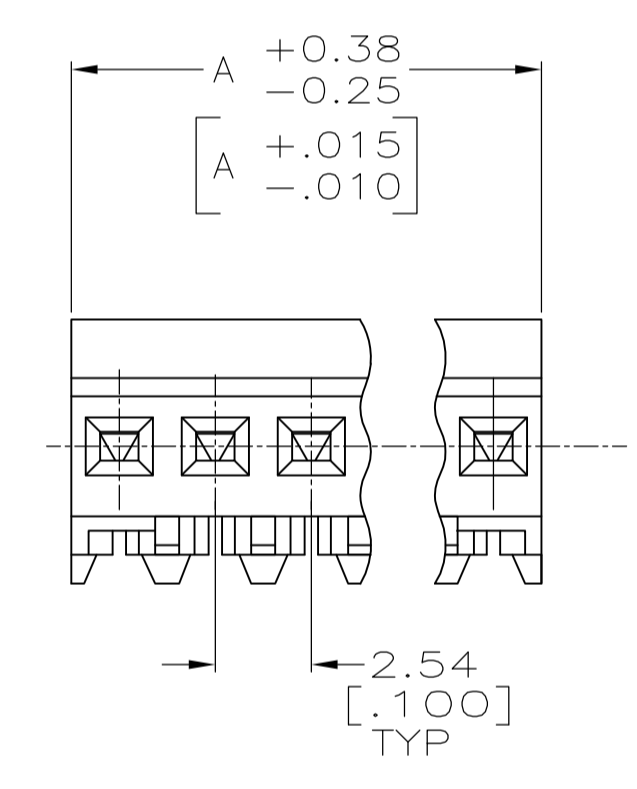
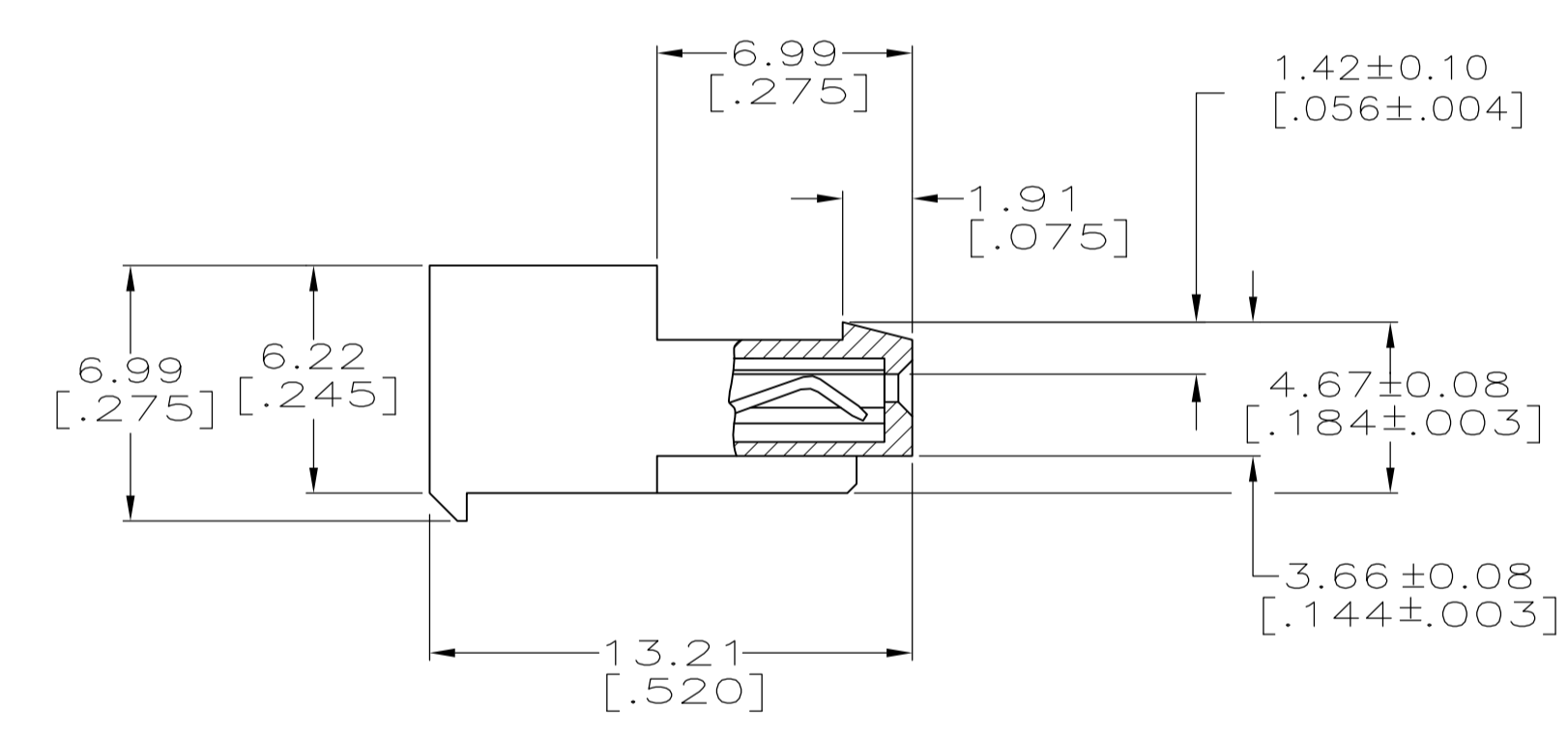
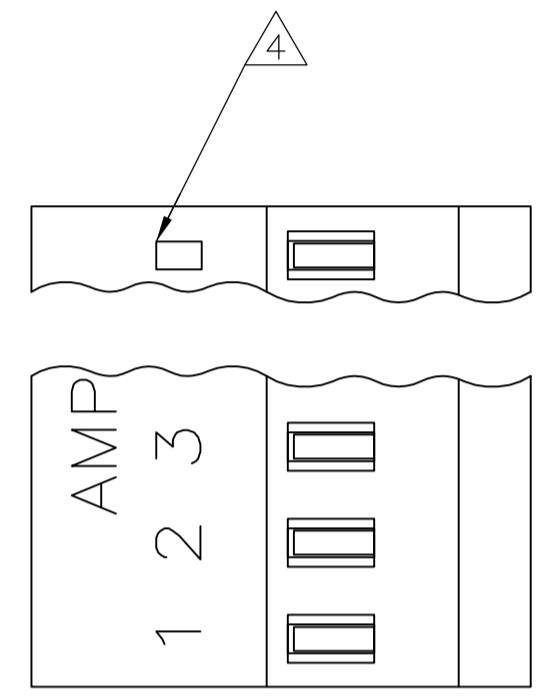

LEAD FREE	71.12 [2.800]	28	5-641240-8	CONTAINS LEAD	71.12 [2.800]	28	2-641240-8
	68.58 [2.700]	27	5-641240-7		68.58 [2.700]	27	2-641240-7
	66.04 [2.600]	26	5-641240-6		66.04 [2.600]	26	2-641240-6
	63.50 [2.500]	25	5-641240-5		63.50 [2.500]	25	2-641240-5
	60.96 [2.400]	24	5-641240-4		60.96 [2.400]	24	2-641240-4
	58.42 [2.300]	23	5-641240-3		58.42 [2.300]	23	2-641240-3
	55.88 [2.200]	22	5-641240-2		55.88 [2.200]	22	2-641240-2
	53.34 [2.100]	21	5-641240-1		53.34 [2.100]	21	2-641240-1
	50.80 [2.000]	20	5-641240-0		50.80 [2.000]	20	2-641240-0
	48.26 [1.900]	19	4-641240-9		48.26 [1.900]	19	1-641240-9
	45.72 [1.800]	18	4-641240-8		45.72 [1.800]	18	1-641240-8
	43.18 [1.700]	17	4-641240-7		43.18 [1.700]	17	1-641240-7
	40.64 [1.600]	16	4-641240-6		40.64 [1.600]	16	1-641240-6
	38.10 [1.500]	15	4-641240-5		38.10 [1.500]	15	1-641240-5
	35.56 [1.400]	14	4-641240-4		35.56 [1.400]	14	1-641240-4
	33.02 [1.300]	13	4-641240-3		33.02 [1.300]	13	1-641240-3
	30.48 [1.200]	12	4-641240-2		30.48 [1.200]	12	1-641240-2
	27.94 [1.100]	11	4-641240-1		27.94 [1.100]	11	1-641240-1
	25.40 [1.000]	10	4-641240-0		25.40 [1.000]	10	1-641240-0
	22.86 [.900]	9	3-641240-9		22.86 [.900]	9	641240-9
20.32 [.800]	8	3-641240-8	20.32 [.800]	8	641240-8		
17.78 [.700]	7	3-641240-7	17.78 [.700]	7	641240-7		
15.24 [.600]	6	3-641240-6	15.24 [.600]	6	641240-6		
12.70 [.500]	5	3-641240-5	12.70 [.500]	5	641240-5		
10.16 [.400]	4	3-641240-4	10.16 [.400]	4	641240-4		
7.62 [.300]	3	3-641240-3	7.62 [.300]	3	641240-3		
5.08 [.200]	2	3-641240-2	5.08 [.200]	2	641240-2		
DIM A	NO.OF POSN	ASSEMBLY	DIM A	NO.OF POSN	ASSEMBLY		

**METRIC**

THIS DRAWING IS A CONTROLLED DOCUMENT.

DIMENSIONS: mm [INCHES]	TOLERANCES UNLESS OTHERWISE SPECIFIED:	DIN S. HOOVER 28-DEC-2004	APPROV D. ROSSI 28-DEC-2004	NAME
0 PLC ±	1 PLC ± 0.13 [.005]	APPROV D. ROSSI 28-DEC-2004	PRODUCT SPEC	MTA .100 CONNECTOR ASSEMBLY
2 PLC ±	3 PLC ±	APPROV D. ROSSI 28-DEC-2004	APPLICATION SPEC	28 AWG, STANDARD
4 PLC ±	ANGLES ±	APPROV D. ROSSI 28-DEC-2004	SIZE	108-1050
FINISH		APPROV D. ROSSI 28-DEC-2004	WEIGHT	114-1019

STE TE Connectivity

CUSTOMER DRAWING SCALE 5:1 SHEET 1 OF 1 REV M